

# IELTS LISTENING

Actual Tests With Answers



EBOOK



AUDIOS



TAPESCRIPTS

JUNE - SEPTEMBER 2021



[www.zandienglish.ir](http://www.zandienglish.ir)



## Table of Contents

Tips and Tricks for different question types. ....	7
Signposting language .....	9
TEST 1 .....	11
Section 1 .....	11
Section 2 .....	11
Section 3 .....	13
Section 4 .....	14
TEST 2.....	16
Section 1 .....	16
Section 2 .....	17
Section 3 .....	18
Section 4 .....	20
TEST 3.....	21
SECTION 1 .....	21
Section 2 .....	21
Section 3 .....	22
Section 4 .....	23
TEST 4.....	25
Section 1 .....	25
Section 2 .....	25
Section 3 .....	27
Section 4 .....	28
TEST 5.....	30
Section 1 .....	30
Section 2 .....	31
Section 3 .....	32
Section 4 .....	34
TEST 6.....	35
Section 1 .....	35
Section 2 .....	36
Section 3 .....	37
Section 4 .....	38

TEST 7.....	39
Section 1 .....	39
Section 2 .....	39
Section 3 .....	40
Section 4 .....	41
TEST 8.....	43
Section 1 .....	43
Section 2 .....	44
Section 3 .....	45
Section 4 .....	46
TEST 9.....	48
Section 1 .....	48
Section 2 .....	49
Section 3 .....	50
Section 4 .....	51
TEST 10.....	53
Section 1 .....	53
Section 2 .....	53
Section 3 .....	55
Section 4 .....	56
TEST 11.....	58
Section 1 .....	58
Section 2 .....	59
Section 3 .....	60
Section 4 .....	62
TEST 12.....	65
Section 1 .....	65
Section 2 .....	65
Section 3 .....	66
Section 4 .....	68
TEST 13.....	71
Section 1 .....	71
Section 2 .....	71
Section 3 .....	73

Section 4 .....	74
TEST 14.....	77
Section 1 .....	77
Section 2 .....	77
Section 3 .....	78
Section 4 .....	80
TEST 15.....	82
Section 1 .....	82
Section 2 .....	83
Section 3 .....	84
Section 4 .....	85
TEST 16.....	88
Section 1 .....	88
Section 2 .....	88
Section 3 .....	89
Section 4 .....	90
TEST 17.....	92
Section 1 .....	92
Section 2 .....	93
Section 3 .....	95
Section 4 .....	96
TEST 18.....	98
Section 1 .....	98
Section 2 .....	99
Section 3 .....	99
Section 4 .....	100
TEST 19.....	101
Section 1 .....	101
Section 2 .....	101
Section 3 .....	103
Section 4 .....	104
TEST 20.....	106
Section 1 .....	106

Section 2 .....	106
Section 3 .....	107
Section 4 .....	108
TEST 21 .....	110
Section 1 .....	110
Section 2 .....	110
Section 3 .....	111
Section 4 .....	112
TEST 22 .....	114
Section 1 .....	114
Section 2 .....	115
Section 3 .....	116
Section 4 .....	117
TEST 23 .....	119
Section 1 .....	119
Section 2 .....	119
Section 3 .....	120
Section 4 .....	122
TEST 24 .....	124
Section 1 .....	124
Section 2 .....	125
Section 3 .....	126
Section 4 .....	127
TEST 25 .....	129
Section 1 .....	129
Section 2 .....	130
Section 3 .....	130
Section 4 .....	131
TEST 26 .....	132
Section 1 .....	132
Section 2 .....	132
Section 3 .....	134
Section 4 .....	135
SOLUTION .....	136

Test 1 .....	136
Test 2 .....	137
Test 3 .....	138
Test 4 .....	139
Test 5 .....	141
Test 6 .....	142
Test 7 .....	143
Test 8 .....	144
Test 9 .....	146
Test 10 .....	147
Test 11 .....	148
Test 12 .....	150
Test 13 .....	151
Test 14 .....	152
Test 15 .....	153
Test 16 .....	154
Test 17 .....	156
Test 18 .....	157
Test 19 .....	158
Test 20 .....	159
Test 21 .....	160
Test 22 .....	161
Test 23 .....	163
Test 24 .....	164
Test 25 .....	165
Test 26 .....	166



# Tips and Tricks for different question types.

## Types of questions in IELTS Listening:

- Multiple choice questions
- Map Labelling questions
- Sentence Completion/Note completion/ Table completion/Diagram completion questions • Match questions

Let's look at the tips and tricks required to answer each question type:

### Multiple Choice Questions

While listening to the audio recording there will be a section for multiple-choice questions. The multiple-choice questions are of two types –

- Multiple choice questions with one answer.
- Multiple choice question with two or more answers

There are questions that have one or more answers, for those type of questions, you would have to listen keenly to identify all the answers from the options given.

There are a few things you would have to keep in mind while you're answering multiple-choice questions:

- You will hear all the options that are given to you in the question. You would have to listen to the audio and interpret the answer from what is asked in the question.
- Sometimes, the answer options might be of the same kind to confuse you. For instance, it might all be in the form of dates ( 15 November, 17 November or 18 November). You would have to read the question and choose the correct answer.
- The words used in the question might not be the exact words that you hear in the audio recording. So, you'd have to pay attention to synonyms and how the words are paraphrased.
- The information provided in the audio recording might not be in the same order as the questions asked, so in order to answer the questions correctly, you should have read the questions beforehand to be aware of what is being asked.
- There would be a lot of distractors in the audio recording. There would be a lot of the same kind of information. Sometimes, the speaker might give us any information and then change it which might be the correct answer. So, do not rush and write down the answer as soon as you hear it.

## Map Labeling questions

For these types of questions, you would be provided with a map and you would have to label the places on the map.

There are two types of questions:

1. A list of words might be given to you and you'd have to listen to the recording and choose the correct word that fits the blank on the map.
2. There won't be a list, you would just listen to the audio and identify the place on the map.

There are a few things you would have to keep in mind while you're answering Map Labeling questions:

- There would be directions to a place or some kind of tour.
- Read the instructions before you begin, so that you'll know the word limit of the blanks.
- Description of the location – listen to words that best describe the location given. For example, below the park, next to the supermarket, etc.
- Look at the question numbers – Look at the question numbers and identify the flow of the map. That would help you listen to what's coming next.
- The audio recording would provide you with an understanding of where you are or where you have to begin at. Pay attention to it at the beginning of the recording. Also, listen to nearby places and clues to help find the answers.

## Sentence Completion/Note completion/ Table completion/Diagram completion questions

In some of the questions, there will be a gap left in between and the examiner asks you to fill that gap. In order to guess the word correctly, you must have solid grammar skills.

There are a few things you would have to keep in mind while you're answering sentence (and other completion) questions:

- Read the question before you start in order to understand what you should be listening for.
- Try to guess what would come in the blank. It could be a place, a number, year, name or even a specific range of information (such as seasons, climatic conditions)
- The words in the question need not necessarily be the same words you hear in the audio recordings, learn to tune yourself to synonyms of the words in the question.
- Though the questions might be phrased differently from the recordings, the answers should be the exact words you hear in the audio.
- Remember to check the word count, spelling and grammar before you transfer your answers to the answer sheet.

## Match questions

These questions are not as common as the other question types but they do occur in the Listening section. These questions have a list of statements that you'd have to match with the options provided. Mostly it would be names, places or dates.

There are a few things you would have to keep in mind while you're answering Match questions:

- Look at the statements and listen keenly to the kind of information that has been provided as options. (i.e) if the options are dates, listen keenly to all the dates in the audio.
- By the side, write down all the information linked to that particular option, it would make it easier for you to find the answer.

## Signposting language

### What is a signposting language?

Signposting means using phrases and words to guide the reader through the content of a passage or a recording. In this case, it's an audio recording. With the help of these phrases and words, the listener can anticipate what's next and find the answer.

Signposting examples:

Purpose	Signposting language
Introduction to the lesson/lecture	<ul style="list-style-type: none"><li>• The purpose of today's lecture is...</li><li>• The subject/topic of my talk is ...</li><li>• The lecture will outline ...</li><li>• The talk will focus on ...</li><li>• Today I'll be talking about / discussing...</li></ul>

	<ul style="list-style-type: none"> <li>• Today we are going to talk about...</li> <li>• The topic of today's lecture is...</li> </ul>
Describing the structure of the lecture	<ul style="list-style-type: none"> <li>• I'm going to divide this talk into a few parts.</li> <li>• First, we'll look at..... Then we'll go on to ... And finally I'll...</li> </ul>
Introducing the topic/ first point / first section	<ul style="list-style-type: none"> <li>• Let's start by talking about...</li> <li>• To begin,...</li> <li>• Firstly,...</li> </ul>
Starting an idea or linking to another idea	<ul style="list-style-type: none"> <li>• Let's move on to...</li> <li>• Now, let's turn to...</li> <li>• And I'd now like to talk about...</li> <li>• Building on from the idea that ...,</li> <li>• Another line of thought on ... demonstrates that ...</li> <li>• Having established ...,</li> </ul>
To reach the end of the talk / Summing up	<ul style="list-style-type: none"> <li>• In conclusion, ...</li> <li>• From the above, it is clear that ...</li> <li>• Several conclusions emerge from this analysis ...</li> <li>• To summarise, ...</li> <li>• I'd like now to recap...</li> </ul>

# TEST 1

Listen to [Audio 1](#) and answer the questions below.

## Section 1

### Questions 1 - 10

Complete the notes below.

Write NO MORE THAN ONE WORD AND/OR A NUMBER in each gap.

#### BANK ACCOUNT OPENING FORM

Type of account:	deposit account
Name of account decided on:	.....1.....
Customer's name:	.....2..... Fox
Date of Birth:	.....3..... 1970
Current address:	10, .....4..... House South Quay
Duration of time living there:	about .....5..... month(s)
Address(before):	Flat 3, Canada House .....6..... Street, Edinburgh
Office number:	02072356735
Home number:	.....7.....
Occupation:	.....8.....
Identity (security):	Name of his .....9..... Monica
The account opening sum:	£.....10.....

## Section 2

## Questions 11 - 20

### Questions 11 - 14

Choose the correct letters A - C

#### The Elizabeth House

11. Jonathan Owen bought the house in 1965 as it was built in the way of

- A. The standard European building style
- B. The Asian style of middle ages in the UK
- C. The traditional middle ages of the Britain

12. Jonathan Owen has been employed in the university of Canterbury as

- A. A head master of ceramic
- B. A head carpenter
- C. A supervisor of accounting

13. Jonathan Owen succeeded in his business so much, but he suffered from

- A. Private household affairs
- B. Personal diseases
- C. Public relations

14. Where did he gather his building material from?

- A. The local area
- B. The garden
- C. The backyard

### Questions 15- 20

Complete the sentences below:

Write NO MORE THAN TWO WORDS in each gap

- Sun Rainbow was designed by Owen's brother who had studied .....15.....in Paris
- There is a .....16.....tree with 200 years old near the entrance
- You can find the shop between the path and .....17.....

- In the snack bar, you will be able to take rest and get .....18.....
- Through .....19..... there is a beautiful walk
- Both .....20..... and grapes are the local products that are promoted and marketed every year with a variety of events and festivals.

## Section 3

### Questions 21 -30

#### Questions 21 - 24

Complete the table below:

Write NO MORE THAN TWO WORDS AND/OR A NUMBER in each gap

#### Gallery Marketing

The place to get information about museums and galleries in England	at 21.....
Research methods	22....., questionnaires or emails
Total respondents	23.....
The compared objects of 24..... fair	Male and Female

#### Questions 25 - 30

Complete the summary below:

Write NO MORE THAN TWO WORDS in each gap

#### Ceramics

Of the countries chosen ceramic of .....25.....is a unique kind that the researchers are interested in. On .....26..... Of ceramic, the decoration is compared with artwork of the present time.

The natives made the ceramic from .....27....., like mountain, basement, and the bottom of the lake. From .....28..... plants, the natives made various colours through the process of .....29..... The tones of ceramic were used by ....30.....

## Section 4

### Questions 31 - 40

#### Questions 31 - 36

Choose the correct letters A - C

#### Waste issues in the UK

31. The waste collection in the UK compared to other European nations

- A. is lower than 15%
- B. will be lower in the next coming years
- C. is lower

32. What did the local government do to reduce waste?

- A. support green campaign and flea markets
- B. enact a severe regulation
- C. investing in flea markets

33. What kinds of flea markets is in the UK?

- A. indoors and outdoors
- B. warehouse and school gymnasium
- C. an open field with many small tents

34. What did the UK flea market vendors sell?

- A. second hand tables and food
- B. unwanted household products
- C. fast food and beverages

35. What hindrance in opening more flea markets is in the UK?

- A. Customers cannot access the internet

- B. There is not enough space and money
- C. the information and marketing are deficient

36. How much waste (electronic and furniture goods) is recycled annually in the UK flea markets?

- A. 20%
- B. 15%
- C. 50%

### **Questions 37 - 38**

Choose two letters A- E

37 & 38. Which two solutions in handling the recycling problems of office papers in the UK?

- A. manufacture high-quality paper to reuse
- B. classify paper before selling.
- C. sell paper to farmers as fertilizer.
- D. put paper through a sorting process
- E. Use high tech machine to produce paper

### **Questions 39 - 40**

Choose two letters A- E

39 & 40. Which TWO reasons are encouraging UK people to reuse waste?

- A. for later use
- B. saving resources
- C. using for other purposes
- D. environmental protection
- E. can be used by others.



# TEST 2

Listen to [Audio 2](#) and answer the questions below.

## Section 1

### Questions 1 - 10

Complete the form below.

Write ONE WORD AND/OR A NUMBER in each gap

#### Hostel accommodation

<b>Top End Backpackers</b> Price per person:	\$19
Comments and reviews:	+ parking available, + staff are .....1..... + nice pool
	+ air-conditioning is too .....2.....
<b>Gum tree lodge</b> Price per person:	\$.....3.....
Comments and reviews:	+ good quiet location + pools and gardens + .....4..... In the dormitories
<b>Kangaroo lodge</b> Price per person:	\$22
Comments and reviews:	+ downtown location + reception at the lodge is always open + no lockers in the rooms + the .....5..... are very clean + seems to be a ...6..... every night
Address:	on .....7..... lane

Hostel information:	+ sheets are provided + can hire a/an .....8..... + .....9..... is included + a shared .....10..... Is available
---------------------	---

## Section 2

### Questions 11 - 20

#### Questions 11 - 16

Choose the correct letters A, B or C

#### Anglia Sculpture Park

11. The land where the sculpture is located was previously completely covered by forest is

- A. completely covered by forest
- B. the site of a private house
- C. occupied by a factory

12. What is unusual about the Anglia Sculpture Park?

- A. artists have made sculptures especially for it
- B. some of its sculptures were donated by the artists
- C. It only shows contemporary sculptures

13. What is the theme of Joe Tremain's sculptures?

- A. The contract between nature and urban life
- B. The effect of man on the environment
- C. the violence of nature

14. The path by the lower lake

- A. is rather wet in some places
- B. has recently been repaired
- C. is difficult to walk on

15. What does the speaker say about the visitor centre?

- A. It is being enlarged at present
- B. It has received an international award
- C. It was designed by a Canadian architect

16. Today, visitors can buy snacks and sandwiches

- A. at the kiosk
- B. in the terrace room
- C. at the Lower Lake café

### Questions 17 - 20

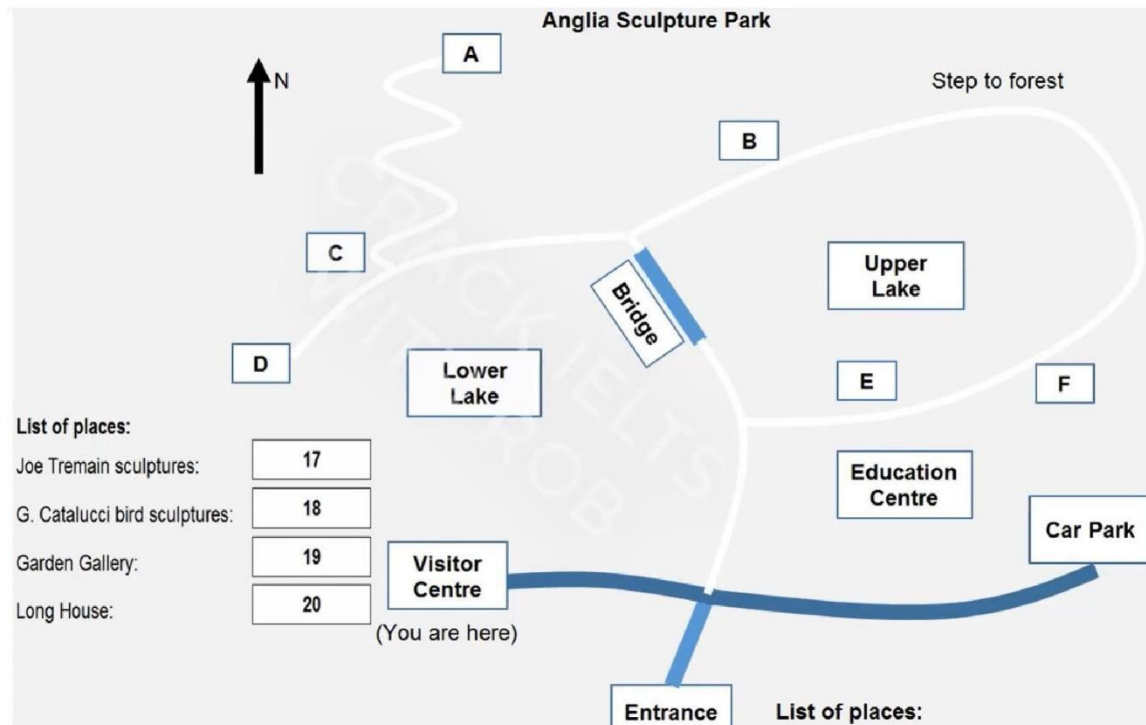

## Section 3

### Questions 21 - 30

#### Questions 21 - 26

Choose the correct letters A, B or C

#### Making Report

21. Why did Leo choose instant coffee as the topic for his marketing report?

- A. he found plenty of material on the topic

- B. he has some practical experience in the area
- C. he had an idea of a brand he wanted to target

22. Leo discovered that in Australia, recent technological developments

- A. are producing less healthy types of instant coffee
- B. are reducing the demand for instant coffee
- C. are improving the quality of instant coffee

23. What do the speakers agree about the Leo's table of coffee products?

- A. it needs more explanation in the text
- B. it is factually inaccurate in some places
- C. it would be best to put this in the appendix

24. What do they decide about Shaffer's coffee as a market follower?

- A. Leo needs to define his terms
- B. Leo needs to provide more evidence
- C. Leo needs to put it in a different section

25. What does Anna say about originality in someone's first marketing report?

- A. Clear analysis of data can be considered original
- B. graphs and diagrams should be original, not copied
- C. reports should contain some original data collected by the student

26. What difference between school assignments and this report has surprised Leo?

- A. not knowing the criteria for getting a good mark
- B. being required to produce work without evidence
- C. having to do a great deal of research

### Questions 27 - 30

Write ONE WORD ONLY in each gap.

### Notes on specific section of marketing report

Executive summary: give a brief overview including the 27.....

Problems: Link each problem to a/an .....28..... which explains it.

Implementation: practical solutions to problems

Includes details such as participants, .....29..... and sequence section is often poorly done because of lack of .....30.....

Conclusion: Don't use raw material here

## Section 4

### Questions 31 - 40

Complete the notes below:

Write ONE WORD ONLY in each gap

#### History of fireworks in Europe

13th - 16th centuries

- fireworks were introduced from china
- Their use was mainly to do with:
  - + war
  - + .....31..... (in plays as festivals)

#### 17th century:

Various features of .....32..... were shown in fireworks

Scientists were interested in using from fireworks displays

To make human .....33..... possible

To show the formation of ....34.....

#### London:

Scientists were distrustful at first

Later they investigated ...35.....uses of fireworks (Eg: for sailors) St. Petersburg:

Fireworks were seen as method of ...36..... for people Paris:

Displays emphasised the power of ...37.....

Scientists aimed to provide .....38..... 18th century:

Italian fireworks specialists became influential Servandoni's firework display followed the same pattern as a/an .....39..... The appeal of fireworks extended to the middle classes

Some displays demonstrated new scientific discoveries such as .....40.....

# TEST 3

Listen to [Audio 3](#) and answer the questions below.

## SECTION 1

### Questions 1 - 10

Complete the notes below.

Write ONE WORD AND/OR A NUMBER in each gap

#### Competition of Writing a Short Story

##### Entry Details

- cost of entry: 5 pounds
- Length of story: approximately .....1.....
- Requirement: Must include a/an .....2..... ending
- Minimum age: .....3.....
- Last entry date: .....4.....
- Web address: www.....5.....com
- Rule: do not .....6..... the story to the organisms

##### Judging and prize details

- Assessments: The story is judged by well known .....7.....
- Prizes: + top five stories will be available.....8.....  
+the top story will be chosen by the .....9.....  
+ the first prize is a place at a writer's workshop in ...10.....

## Section 2

### Questions 11 - 20

#### Questions 11 - 17

Complete the sentences below:

Write ONE WORD ONLY in each gap

## Information of Sea Life Centre

- The Sea Life centre was previously called as the World of .....11..... - The newest attraction at the centre is the splash .....12.....
- The main feeding time at the centre is at .....13.....
- Visitors can feed the .....14.....with a VIP ticket
- A small party will be arranged by the centre for visitor's .....15.....
- The petition for animal conservation will be sent to .....16.....
- A/An .....17..... can be used to test what visitor has learnt

### Questions 18 - 20

18,19 & 20. What does the guide say about each attraction?

Choose THREE answers from the list below and write the correct letter A - E, next to questions 18 - 20.

List of attractions:

Comments:

- |                   |                    |              |
|-------------------|--------------------|--------------|
| A. Aquarium       | must not miss      | .....18..... |
| B. Crocodile cave | temporarily closed | .....19..... |
| C. Penguin park   | large queues       | .....20..... |
| D. Seal centre    |                    |              |
| E. Turtle town    |                    |              |

## Section 3

### Questions 21 - 30

#### Questions 21 - 22

Choose two letters A - E,

21 & 22. Which TWO subjects did Martina like best before going to university?

- A. Art
- B. English
- C. French D. History
- E. Science

Questions 23 - 26

Complete the summary below:

Write ONE WORD ONLY in each gap

### **George's Experience of University**

George is studying Mechanical Engineering which involves several disciplines. He is finding .....23..... the most difficult. At the moment, his course is only .....24..... He will soon have an assignment which involves a study of jet .....25..... He thinks there are too many ....26..... and would like less of them.

#### **Questions 27 - 30**

Choose the correct letters A, B or C

27. Martina thinks that the students at her university are

- A. sociable
- B. intelligent
- C. energetic

28. George hopes that his tutor will help him

- A. lose his shyness
- B. settle into university
- C. get to know his subject better

29. What does Martina know about her first assignment?

- A. the topic
- B. the length
- C. the deadline

30. George would like to live

- A. In a hall of residence
- B. in a flat of his own
- C. with a host family

## **Section 4**

#### **Questions 31 - 40**

### Questions 31 - 35

Complete the notes below:

Write ONE WORD ONLY in each gap:

#### Preparation Process of Making a Presentation

Initial thoughts:

Most important consideration: your audience

Three points to bear in mind

+ what they need to know

+ how .....31..... they will be

+ how big the audience will be Structure:

Start with information that draws the audience's .....32..... end

with next .....33.....

Design:

The presentation needs to be .....34.....

Vary content by using a mix of words and .....35.....

### Questions 36 - 40

Presenting:

Look at the audience, be enthusiastic and energetic

Voice - vary speed and .....36.....

Occasionally add .....37.....

Do not use weak .....38..... (e.g: appears, seems)

Questions and interruptions:

When asked a question, first of all you should .....39..... it

Minimise interruptions by .....40..... them.



# TEST 4

Listen to [audio 4](#) and answer the questions below.

## Section 1

### Questions 1 - 10

Complete the notes below.

Write NO MORE THAN ONE WORD AND/OR A NUMBER in each gap **Goodbye party for John**

Venue:	College Dining room
Invitations (Tony) Who to invite:	- John and his .....1..... -Director - the office .....2..... - all the teachers - all the .....3.....
Date for sending invitations: <b>Present (Lisa)</b>	.....4.....
Collect money:	- coffee breaks -\$ .....5.....
Check prices for:	- CD players - set of .....6..... - coffee .....7.....
Ask guests to bring:	-snacks -music .....8..... - .....9.....
Ask students to prepare a	-.....10.....

## Section 2

### Questions 11 - 20

#### Questions 11 - 15

Choose the correct letters A - C

11. To find out how much holidays cost, you should press button

A. one

- B. two
- C. three

12. Travelite currently offer walking holidays

- A. only in Western Europe
- B. all over Europe
- C. Outside Europe

13. The walks offered by Travelite

- A. cater for a range of walking abilities
- B. are planned by guides from the local area
- C. are for people with good fitness levels

14. On travelite holidays people holidaying alone play

- A. the same as other clients
- B. only a little more than other clients
- C. extra only if they stay in a large room.

15. Entertainment is provided

- A. When guests request it
- B. most nights
- C. every night

### Questions 16 - 20

Complete the table below.

Write **NO MORE THAN TWO WORDS OR A NUMBER** in each gap.

Length of holiday	Cost per person (including all accommodation costs)	Special offers included in price
3 days	\$ 16	Pick up from the 17
7 days	\$350	As above plus: - book of 18 - maps
14 days	\$ 19	As above plus membership of a 20

## Section 3

### Questions 21 - 30

#### Questions 21 - 26

Complete the table below

Write NO MORE THAN ONE WORD AND/OR A NUMBER in each gap

Experiment number	Experiment	Purpose
Experiment 1	<b>21</b> and a table	To show how things move on a cushion of air
Experiment 2	Lots of paperclips	To show why we need standard unit of <b>22</b>
Experiment 3	<b>23</b> salt and a jar of water	To show how <b>24</b> grow
Experiment 4	Cardboard, colored pens and a <b>25</b>	To teach children about how is made up <b>26</b>
Experiment 5	A drill, an old record, a needle, paper, a bolt	To make a record player in order to learn about recording sound

#### Questions 27 - 30

What problems do the speakers identify for each experiment?

Match your answers A - H from the box next to questions 27 - 30

A. too messy	Experiment 1: .....27.....
B. too boring	
C. too difficult	Experiment 2: .....28.....
D. too much equipment	
E. too long	Experiment 3: .....29.....
F. too easy	

G. too noisy	Experiment 4: F
H. too dangerous	Experiment 5: .....30.....

## Section 4

### Questions 31 - 40

#### Questions 31 - 34

Complete the note below

Write NO MORE THAN ONE WORD AND/OR A NUMBER in each gap

#### Shark in Australia

Length:	largest caught	16 metres
Weight:	Heaviest	31..... kg
Skeleton:	Cartilage	
Skin texture:	Rough barbs	
Swimming aids:	fins and .....32.....	
Food:	gathered from the ocean .....33..... Sharks locate food by using their sense of .....34.....	

#### Questions 35 - 38

Choose the correct letters A - C

35. Sharks meshing uses nets laid

- A. along the coastline
- B. At an angle to the beach
- C. from the beach to the sea

36. Other places that have taken up shark meshing include

- A. South Africa
- B. New Zealand

C. Tahiti

37. The average number of sharks caught in nets each year is

- A. 15
- B. 150
- C. 1500

38. Most sharks are caught in

- A. spring
- B. summer
- C. winter

**Questions 39 - 40**

Choose TWO letters A - G

39 & 40. Which TWO factors reduce the benefits of shark nets?

- A. net wrongly positioned
- B. strong waves and currents
- C. too many fish
- D. sharks eat holes in nets
- E. moving sands
- F. nets too short
- G. holes in nets scare sharks

# TEST 5

Listen to [audio 5](#) and answer the questions below.

## Section 1

### Questions 1 - 10

Complete the notes below.

Write ONE WORD AND/OR A NUMBER in each gap

#### Bankside Recruiting Agency

Address: 497, Eastside, Docklands  
Name of agent: Becky.....1.....  
Phone number: 07866510333  
Time to contact: Best time to call her in the .....2.....  
Typical jobs: Clerical and admin roles, mainly in the finance industry  
Must have good .....3..... skills  
Jobs are usually for at least one .....4..... Pay  
is usually £.....5..... per hour

Registration process:

Wear a .....6..... to the interview  
Must bring your .....7..... to the interview  
They will ask questions about each applicant's .....8.....

Further information:

The .....9..... you receive at interview will benefit you. Will  
get access to vacancies which are not advertised.  
Less .....10..... is involved in applying for jobs.

## Section 2

### Questions 11 - 20

#### Questions 11 - 14

Choose the correct letters A - C

#### Matthews Island Holidays

11. According to the speaker, the company

- A. has been in business for longer than most of its competitors
- B. arranges holidays to more destinations than its competitors
- C. has more customers than its competitors

12. Where can customers meet the tour manager before travelling to the Isle of Man?

- A. Liverpool
- B. Heysham
- C. Luton

13. How many lunches are included in the price of holidays?

- A. three
- B. four
- C. five

14. Customers have to pay extra for

- A. guaranteeing themselves a larger room
- B. booking at short notice
- C. transferring to another date

### Questions 15 - 20

Write ONE WORD AND/OR A NUMBER in each gap

Time table for Isle of Man Holiday		
	Activity	Notes
Day 1	Arrive	<ul style="list-style-type: none"><li>- Introduction by manager</li><li>- Hotel dining room has view of the 15.....</li></ul>
Day 2	Tynwald Exhibition and Peel	Tynwald may have been founded in 16..... not 979.
Day 3	Trip to Snaifell	Travel along promenade in a tram; train to Laxey; train to 17..... of Snaifell
Day 4	Free day	Company provides a 18..... for local transport and heritage sites.
Day 5	Take the 19.....railway train from Douglas to Port Erin	Free time, then coach to Castletwon- former 20..... has old castle.
Day 6	Leave	Leave the island by Ferry or plane.

## Section 3

### Questions 21 - 30

#### Questions 21 - 26

What did findings of previous research claim about the personality traits a child is likely to have because of their position in the family?

Choose SIX answers from the list below and match the correct letter, A - H to question 21 - 26

Personality traits	Position in the family
A. outgoing	the eldest child .....21.....
B. selfish	a middle child .....22.....
C. independent	the youngest child .....23.....
D. attention-seeking	a twin .....24.....
E introverted	an only child .....25.....
F. co-operative	a child with much older siblings.....26.....
G. caring	
H. competitive	

### Questions 27 - 28

Choose the correct letters A - C.

27. What do the speakers say about the evidence relating to birth order and academic success?

- A. There is conflicting evidence about whether oldest children perform best in intelligence tests.
- B. There is little doubt that birth order has less influence on academic achievement than socioeconomic status
- C. Some studies have neglected to include important factors such as family size.

28. What does Ruth think is surprising about the difference in oldest children's academic performance?

- A. It is mainly thanks to their role as teachers for their younger siblings.
- B. The advantages they have only lead to a slightly higher level of achievement.
- C. The extra parental attention they receive at a young age makes little difference.

### Questions 29 - 30

Choose TWO letters A - E

29&30. Which TWO experiences of sibling rivalry do the speakers agree has been valuable for them?

- A .learning to share
- B .learning to stand up for oneself
- C .learning to be a good loser

- D .learning to be tolerant
- E .learning to say sorry

## Section 4

### Questions 31 - 40

Complete the notes below

Write ONE WORD ONLY in each gap

#### The Eucalyptus Tree in Australia

Importance:

It provides .....31..... And food for a wide range of species

Its leaves provide .....32..... Which is used to make a disinfectant

Reasons for present decline in number:

Diseases

(i) 'Mundulla Yellow'

- Cause - lime used for making .....33..... Was absorbed.
- Trees were unable to take in necessary iron through their roots.

(ii) 'Bell miner associated Dieback'

- Cause .....34..... feed on Eucalyptus leaves
- They secrete a substance containing sugar
- Bell miner birds are attracted by this and keep away other species

#### Bushfires

William Jackson's theory:

- High frequency bushfires have an impact on vegetation resulting in the growth of .....35..... -  
Mid frequency bushfires result in the growth of eucalyptus forests because they make more  
.....36..... Available to the trees.
- Maintain the quality of the .....37.....
- Low frequency bushfires result in the growth of .....38..... rainforest's which is: a  
.....39..... ecosystem, an ideal environment for the .....40..... of the bell  
miner.

# TEST 6

Listen to [audio 6](#) and answer the questions below.

## Section 1

### Questions 1 - 10

#### Questions 1 - 5

Complete the form below.

Write NO MORE THAN ONE WORD AND/OR A NUMBER in each gap.

#### VIDEO LIBRARY APPLICATION FORM

First names: Louise Cynthia  
Address: Apartment 1, 72 ..... street  
Highbridge  
  
Postcode: .....2.....  
Telephone: 9835 6712 (home)  
.....3.....(work)  
  
Driver's license number: .....4.....  
Date of birth: Day: 25th Month: .....5..... Year: 1977

#### Questions 6 - 8

Choose three letters A - F

6,7 & 8. What type of films does Louise like?

- A. Action
- B. Comedies
- C. Musicals
- D. Romance
- E. Westerns
- F. Wildlife

#### Questions 9 - 10

Write NO MORE THAN TWO WORDS for each answer.

How much does it cost to join the library? .....9.....

When will Louise's card be ready? .....10.....

## Section 2

### Questions 11 - 20

#### Questions 11 - 13

Complete the note below

Write NO MORE THAN TWO WORDS in each gap

#### **Expedition across Attora mountains**

Leader: Charles Owen

Prepared a 11..... for the trip

Total length of the trip 12.....

Climbed highest peak in 13.....

#### Questions 14 - 15

Choose the correct letters A - C

14. What took the group by surprise?

- A. the amount of rain
- B. the number of possible routes
- C. the length of the journey

15. How did Charles feel about having to change routes?

- A. He reluctantly accepted to it
- B. He was irritated by the diversion
- C. It made no difference to his enjoyment.

#### Questions 16 - 18

Choose THREE letters A - F

16,17 & 18. What does Charles say about his friends?

- A .He met them at one stage on the trip
- B .They kept all their meeting arrangements
- C .One of them helped arrange the transport
- D .One of them owned the hostel they stayed in
- E .Some of them travelled with him
- F .Only one group lasted the 96 days

### Questions 19 - 20

19 & 20 Choose TWO letters A - E What does Charles say about the donkeys?

- A. He rode them when he was tired
- B. He named them after places
- C. One of them died
- D. They behaved unpredictably
- E. They were very small

## Section 3

### Questions 21 - 30

#### Questions 21 - 25

Complete the table below.

Write **NO MORE THAN ONE WORD OR A NUMBER** in each gap.

	TIM	JANE
Day of arrival	Sunday	<b>21</b>
Subject	History	<b>22</b>
Number of books to read	<b>23</b>	<b>24</b>
Day of first lecture	Tuesday	<b>25</b>

#### Questions 26 - 30

Write NO MORE THAN THREE WORDS for each answer

What is Jane's study strategy in lectures?	.....26.....
What is Tim's study strategy for reading?	.....27.....
What is the subject of Tim's first lecture?	.....28.....
What is the title of Tim's first essay?	.....29.....
What is the subject of Jane's first essay?	.....30.....

## Section 4

### Questions 31 - 40

#### Questions 31 - 35

Complete the table below

Write NO MORE THAN TWO WORDS in each gap

Course	Type of course: duration and level	Entry requirements
Physical Fitness Instructor	Example Six-month certificate	None
Sports Administrator	.....(31).....	(32)..... in sports administration
Sports Psychologist	(33).....	Degree in psychology
Physical Education Teacher	Four-year degree in education	(34).....
Recreation Officer	(35).....	None

#### Questions 36 - 40

What is the main role of each job? Choose the correct answer and move it into the gap.

Job	Main role
Physical fitness instructor .....36.....	A the coaching of teams
Sports administrator .....37.....	B the support of elite athletes
Sports psychologist .....38.....	C guidance of ordinary individuals
Physical education trainer .....39.....	D community health
Recreation officer .....40.....	E the treatment of injuries
	F arranging matches and venues
	G the rounded development of children

# TEST 7

Listen to [audio 7](#) and answer the questions below.

## Section 1

### Questions 1 - 10

Complete the form below.

Write ONE WORD AND/OR A NUMBER in each gap.

#### Properties in Accommodation

Name:	Jane Ryder
Phone number:	(0044) .....1.....
Email address:	richard@.....2.....co.uk
Occupation:	a local .....3.....
Type of accommodation:	- a 2-bedroom apartment wanted (must have its own .....4.....) - no .....5..... Required (family bringing theirs) - a/an .....6..... in the kitchen is preferable
Preferred location:	near a/an .....7.....
Maximum rent:	.....8..... per month
Other requests:	the accommodation has to be .....9..... In the daytime
How did you hear?	Through a/an .....10.....

## Section 2

### Questions 11 - 20

#### Questions 11 - 15

Complete the sentences below

Write ONE WORD ONLY in each gap

#### Safety Guidelines

- The police officer suggests neighbours give each other their details of .....11.....

- Neighbours should discuss what to do if there's any kind of .....12..... - It's a good idea to leave on the .....13.....
- Think carefully about where you put any .....14.....
- It's a good idea to buy good quality .....15.....

### Questions 16 - 20

Choose FIVE answers from the list below and write the correct letter, A - G, next to questions 16 - 20.

Proposed crime prevention measures

- A. install more lighting
- B. have more police officers on patrol
- C. remove surrounding vegetation
- D. Contact local police
- E. fix damage quickly
- F. change road design
- G. use security cameras

List of jobs:

- skate park .....16.....
- local primary schools .....17.....
- Abbotsford street .....18.....
- Shops on Victoria street .....19.....
- supermarket car park .....20.....

## Section 3

### Questions 21 - 30

#### Questions 21 - 25

Choose the correct letters A, B or C

#### Food Waste

21. What point does Robert make about the 2013 study in Britain?

- A. it is focused more on packaging than wasted food
- B. it proved that households produced more waste than restaurants.
- C. it included liquid waste as well as solid waste

22. The speakers agree that food waste reports should emphasize the connection between carbon dioxide emissions and

- A. food production
- B. transport of food to landfill sites
- C. distribution of food products

23. Television programs now tend to focus on

- A. the nutritional value of food products
- B. the origin of food products
- C. the chemicals found in food products

24. For Anna, the most significant point about food waste is

- A. the moral aspect
- B. the environmental impact
- C. the economic effect

25. Anna and Robert decide to begin their presentation by

- A. handing out a questionnaire
- B. providing statistical evidence
- C. showing images of wasted food.

### Questions 26 - 30

What advantages do the speakers identify for each of the following projects?

Choose FIVE answers from the list below and write the correct letter, A - G next to questions 26 - 30

List of advantages:

- A it should save time
- B it will create new jobs
- C it will benefit local communities
- D it will make money
- E it will encourage personal responsibility
- easy to advertise
- G it will involve very little cost

List of projects:

- edible patch .....26.....
- ripeness sensor .....27.....
- waste tracking technology .....28.....
- smartphone application .....29.....
- food waste composting.....30.....

F it will be

## Section 4

### Questions 31 - 40

Write ONE WORD ONLY in each gap

Kite-making by the Maori people of New Zealand

Making and appearance of the kites:

- the priests who made the kites had rules for size and scale
- .....31..... was not allowed during a kite's preparation

Kites:

- often represented a bird, a god, or a/an .....32.....
  - had frames that were decorated with grasses and .....33.....
  - had a line of noisy .....34..... attached to them
  - could be triangular, rectangular or .....35..... shaped
  - Had patterns from clay mixed with .....36..... oil
  - sometimes had human head masks with .....37..... and a tattoo
- Purpose and function of kites:
- a way of sending .....38..... to gods
  - a way of telling other villages that a/an .....39..... was necessary
  - a mean of .....40..... If enemies were coming

# TEST 8

Listen to [audio 8](#) and answer the questions below.

## Section 1

### Questions 1 - 10

#### Questions 1 - 7

Complete the form below.

Write ONE WORD AND/OR A NUMBER in each gap.

English courses for international students

Course available:	- writing in first term - .....1..... in second term - .....2..... and grammar throughout the year
	- .....3..... cases during long vacation
Class sizes:	maximum capacity is .....4.....
Costs:	often paid by the .....5.....
Exams:	available in .....6.....
Enrollment:	must enroll by .....7.....

#### Questions 8 - 10

Write THREE letters, A - G

8,9 &10. Which THREE items does the student need to bring to the first class?

- A passport
- B computer disk
- C note from tutor
- D notebook
- E student identity card
- F dictionary
- G registration form

## Section 2

### Questions 11 - 20

#### Questions 11 - 15

Which types of transport is true with the following features?

Choose FIVE answers from the box and write the correct letter, A - C, next to questions 11 - 15

Transportation

- A. tube
- B. train
- C. bus

#### Features of transport

cheapest .....11.....  
most convenient.....12.....  
most comfortable.....13.....  
fastest .....14.....  
most frequent service .....15.....



### Questions 16 - 20

The map has seven gaps, A-G. Choose the correct gap and move it into the corresponding place.

The map shows a town center with the following layout:

- High Street** runs horizontally across the top.
- South Street** runs vertically down the left side.
- Heart Lane** runs vertically down the right side.
- Swivel Street** is a small street branching off High Street to the left.
- Locations:**
  - Information Office** is on the left side of High Street.
  - Bank** is on the right side of High Street.
  - Post office** is on the right side of High Street.
  - Cinema** is on the left side of South Street.
  - bus stop** is on the right side of South Street.
- Gaps A-G:**
  - A** is on the left side of High Street.
  - B** is on the left side of High Street.
  - C** is on the left side of South Street.
  - D** is on the right side of High Street.
  - E** is on the right side of High Street.
  - F** is on the right side of South Street.
  - G** is on the right side of Heart Lane.

**List of places**

bus stop:	16
train station:	17
tube entrance:	18
transport ticket office:	19
taxi rank:	20

## Section 3

### Questions 21 - 30

#### Questions 21 - 23

What is the advantage of each course?

Choose THREE answers from the box and write the correct letter A - E next to questions 21 - 23

Advantages of the course

Courses

A. will be tested in the final exams  
useful for a future job

Science and ethics .....21.....  
Pharmacology prelim.....22.....

B. will be

C. will help with research skills  
will improve writing skills  
E. will support material already covered

Reporting test results.....23..... D.

### Questions 24 - 30

Complete the sentences below

Write ONLY ONE WORD in each gap

- The Maths course will run in the .....24..... term
- The tutor for Pharmacology is visiting from .....25.....
- .....26..... for the project must be submitted by the end of January - Resources for experiments are available in the newly built .....27.....
- Extra ...28.....will be held in December
- Students are allowed to do presentations in .....29.....
- Course assessment will be based on a/an .....30.....

## Section 4

### Questions 31 - 40

#### Questions 31 - 37

Complete the table below.

Write **ONLY ONE WORD** in each gap.

	New Features	Size	Problems
Transport	individual transportation 31	roads will be 31	levels of investment
Commercial areas	roofs will have 32	one fifth of current area	33 will be limited to outskirts
Residential areas	homes made of 34	will be limited to 15,000	providing enough housing for 35 citizens
Energy sources	36 will be an energy source	energy plants will be smaller	noise and congestion caused by 37

### Questions 38 - 40

Choose THREE letters, A - F

38, 39 & 40. Which THREE types of accommodation does the speaker say will increase in the city centres?

- A. flats for rent
- B. social housing
- C. homes for retired people
- D. private housing
- E. buildings for a company and residing
- F. smart apartments

# TEST 9

Listen to [audio 9](#) and answer the questions below.

## Section 1

### Questions 1 - 10

Write NO MORE THAN THREE WORDS AND/OR A NUMBER for each answer.

#### Wildlife conservation society

#### Application for membership

Heard of WCS from: 1.....	
Address:	21, Beel street, Leeds
Postcode:	2.....
Phone number:	01173 58642
Email address:	3. mj@.....
Length of membership: Type of membership: Fee	4..... years 5..... 6. £.....
Payment details:	direct debit
Name of bank:	7.....
Account name:	Michael Jones
Account number:	01059612
Date of first payment:	8.....
Reference number:	9.....

Other requests:	- extra information pack  -10.....
-----------------	--

## Section 2

### Questions 11 - 20

#### Questions 11 - 18

Write NO MORE THAN TWO WORDS AND/OR A NUMBER for each answer.

#### Spring Festival

Event	Location	Date and Time	Other Information
Firework display	Near the 11 _____	4 September 9 p.m.	Pack a 12 _____ and blanket
Display of 13 _____	Central Park	Daily	Buses run from the town centre every 14 _____ minutes
The 15 _____ Show	Exhibition Centre	10—15 September 9 a.m.—10 p.m.	
"Grow Your Imagination"	in the 16 _____	11—19 September	
"Swing in Spring"	in the 17 _____	17&18 September	Saturday matinee Performance at 18 _____

#### Questions 19 - 20

Choose the correct letter A, B or C

19. In the Spring Festival competition, you can win

- A. A family pass to "Balloon down under"
- B. A cheque for \$200.
- C. A flight in a hot air balloon.

20. You can get an entry form for the competition from

- A. the radio station
- B. the newspaper
- C. the festival's website

## Section 3

### Questions 21 - 30

Write NO MORE THAN THREE WORDS for each answer.

Archeology course:

- Can be combined with any other subject except with 21.....
- Has three 22..... modules in first semester

#### Module 1

Title:	23.....
Lecturer:	Dr. Morris
Learning method:	Lectures and practical sessions
Content:	Based on processes Recording
	24.....
	Interpretation
	Display
Assessment:	By 25.....

#### Module 2

Title:	26.....
Lecturer:	Prof. Elliot
Content:	27..... And development of built environments
Assessment:	By 28..... examination

### Module 3

Title:	Method and Science
Lecturer:	Dr. Thompson
Content:	Standard techniques in fieldworks and analysis
Learning method:	50% lab work, 50% 29.....
Site survey at the end of module:	(the 30..... is to be announced later)

## Section 4

### Questions 31 - 40

#### Questions 31 - 33

Choose the correct letter, A, B or C

31. What impact does Marc Prensky believe that digital technology has had on young people?

- A. It has altered their thinking patterns
- B. It has harmed their physical development
- C. It has limited their brain capacity

32. "Digital immigrants" tend to access computers

- A. using their native language
- B. less efficiency than young people
- C. for less important information

33. What example is given of having a "digital accent"?

- A. Having less effective typing skills
- B. Doing thing the old-fashioned way
- C. Being unable to understand instructions

#### Questions 34 - 40

Which theorist makes each of the following points?

Choose the correct letter, A, B or C next to questions 34 - 40

## Theorists

- A. Allen
- B. James
- C. Vander

Points made:

- 34. Current teaching methods don't work .....
- 35. Many students don't understand computers.....
- 36. Computer technology doesn't interest all students.....
- 37. Students can still learn the traditional way .....
- 38. Students still need to learn research skills .....
- 39. We should use computer games to teach .....
- 40. Computers can't replace educators .....

# TEST 10

Listen to [audio 10](#) and answer the questions below.

## Section 1

### Questions 1 - 10

Write ONE WORD AND/OR A NUMBER in each gap

#### Advertisement for Old Laptop

Condition:	Almost new
Weight:	.....1..... Make: Allegro
Memory:	.....2.....GB
Screen:	.....3.....
Touchpad:	With cordless mouse
of ports:	02 Number
Battery:	Lasts around .....4.....
Lab test programs:	Not .....5..... Extras:
	- webcam
	-printer with scanner and .....6.....
	- smart case
Price:	£.....7.....
Contact details:	
Name:	David .....8.....
E-mail address:	DIB-7791@hotmail.com
Mobile number:	.....9.....
Advert placed on:	.....10.....

## Section 2

### Questions 11 - 20

#### Questions 11 - 12

Choose TWO letters A - E

11 & 12. What TWO changes to the organization of this year's festival are mentioned?

A. free parking

- B. free refreshments
- C. new uniforms
- D. free concert
- E. large tents

### Questions 13 - 15

Complete the table below:

Write NO MORE THAN TWO WORDS AND/OR A NUMBER in each gap.

Teams	Purpose	Meeting point	Time
Beach team	Pick up litter, etc	13 .....	8 am
Town team	Arrange 14.....	Village hall	15 .....

### Questions 16 - 20

Choose the correct letters A, B or C

16. What does the speakers say about the judges in the competitors?

- A. Most people judging will have some experience
- B. None of the judges will have experience
- C. Every judge will be experienced

17. The winner in each of the competitions will

- A. be given vouchers
- B. be awarded a cash prize
- C. receive book-tokens

18. The profits from the marathon will be given to the Children's hospital to help

- A. buy new specialist equipment
- B. decorate the hospital wards
- C. provide the books for the children

19. Wardens will be needed at the car park

- A. they helped organize the parking well last year
- B. The parking last year was dis-organized
- C. They will be needed to collect parking fees

20. Bags will be provided by the council

- A. for all the rubbish
- B. Only for the food rubbish
- C. only for the material that can be recycled

## Section 3

### Questions 21 - 30

#### Questions 21 - 22

Complete the sentences below:

Write NO MORE THAN TWO WORDS in each gap

Study methods

People usually spend approximately 21..... on concentrating their lectures  
The optimal method to approach lectures is to do the necessary 22..... in advance.

#### Questions 23 - 26

What were students' opinions on the study techniques?

Choose FOUR answers from the box and write the correct letter A - C next to questions 23 - 26

Opinions

Technique

- A good method
- B no strong opinion
- C was not good method

writing essay plans: .....23.....  
discussing ideas: .....24.....  
reading whole chapters .....25.....  
Skim reading .....26.....

#### Questions 27 - 30

27. According to the research that Susan conducted, most students believe

- A. time management is generally quite important
- B. time management isn't very important
- C. time management is very important to young students

28. What did students complain about their studies?

- A. They had to get up early in the morning.
- B. They had to earn money to support their studies
- C. They had to work part time on weekends

29. Susan discovered that most of the students she surveyed

- A. would prefer it if they didn't have exams
- B. actually quite liked exams
- C. actually dreaded the exams

30. What were Susan's findings on exam prediction techniques?

- A. All the younger students like to prepare the exams in a short time,
- B. Few older students spent much time on revising
- C. A few younger students study the whole night.

## Section 4

### Questions 31 - 40

Complete the notes below:

Write ONE WORD ONLY in each gap

Architecture roles in people's lives Implementation plan:

- The purpose of data collection was to test people's 31....., i.e. unhappy, happy
- The initial plan to use a questionnaire was abandoned, because it was extremely 32.....
- The scale method was rather 33.....to collect people's response
- The final images were produced by aiding of 34..... resources
- The chosen images were preserved by stiff 35.....
- People who formed part of the sample were 36..... from various places.
- Appointing a leader for the group was to keep the team not going various 37.....

Reaction of respondents:

- The reaction of the 11- 18- year-old group was utmost .....38.....
- The 20-40-year-old group mostly scored about .....39.....
- Approximately 40.....respondents who had no response



# TEST 11

Listen to [audio 11](#) and answer the questions below.

## Section 1

### Questions 1- 10

#### Question 1-5

Complete the table below.

Write ONE WORD AND/OR NUMBERS for each answer.

JOB HUNTING			
Company's Name	Job details	Reference number	Contact
Example POWER (manufacturing company)	• Work in a 1..... section	SW35FT	Jane 2 .....
COTTON (grocery company)	• Good pay • Work in 3..... office in a 4..... • chance of promotion	5 .....	Go to office

#### Question 6 -10

Complete the notes below Write ONE WORD  
ONLY for each answer.

#### Notes on Jobs

- Local jobs can be found in the 6.....
- Buy the 7 ..... to get one free magazine (Job Plus)

- Feel stress and spend a lot of time looking for jobs
- Advisable to go to an 8. .... instead of the recruitment seminar • Bring a student card (10% discount)
- Referee:
  - former boss (once had a job)
  - one of the 9. .... (if not)
- Intend to take the art course
- Fill out a 10 ..... form at the end of the course.

## Section 2

### Questions 11-20

Complete the notes below.

Write NO MORE THAN TWO WORDS for each answer.

#### Tower Hill Pageant Londinium

Romans built 11 ..... linked by roads.  
Londinium was a port.

#### Lundenwic

It was the port of London in 12. .... Aldwych is a street named after 'old port' in Old English.

People sold goods and 13. ....

English King Alfred moved the population to the Roman walls so as to defend against 14 .....

#### London prior to Norman Conquest

King Edward built a church in 'Westminster'.

He also built a palace for 15. .... William Conqueror built 16 ..... , including the Tower of London.

He also had the Domesday Book - it was a 17 ..... about the land and livestock in British counties.

#### Mediaeval London

Imports would go to the quays. Exports were taken to Customs House and 18. .... were collected. The fire was a constant threat in mediaeval London.

### **Tudor London**

- Fine houses were located to the west of London.
- The Globe Theatre was direct across from the first stone bridge.
- Commerce was within 19. ....

The first stone bridge had 19 arches and a 20..... which was raised when an attack would occur.

## **Section 3**

### **Questions 21 - 30**

#### **Question 21 - 26**

Choose the correct letter, A, B or C.

#### **Willows Studies**

21 What field is Willows currently focused on?

- A.. Specialising in one product
- B. making a variety of products
- C. adding a lot of retail outlets

22. How did the students feel about the software?

- A. The professor contacted the company.
- B. An article was read in a newspaper
- C. A student works part-time during the vacations.

23. How did the student feel about the software?

- A. It's not easy to predict.
- B. It's slow for drawing designs
- C. It had a good interface.

24 How did the students find out about the effects of the software on the company?

- A. They went to the IT department.
- B. They talked with the manager. C. They inspected the accounts.

25 The reason why the students have a face-to-face interview alone is that

- A. they could prepare for exams.
- B. there will be less disturbance.
- C. it's less realistic.

26 How did the two students perform in the exam?

- A. very disappointing
- B. significantly good
- C. above the average

**Question 27 – 28**

Choose TWO letters, A-E.

27 & 28. In which TWO ways will the new system affect the company?

- A. gain more profit
- B. employ more new staff
- C. increase sales
- D. reduce production time
- E. cut labour costs

**Questions 29 and 30**

Choose TWO letters.

29 & 30. Which TWO effects will the new system have on new clients?

- A. getting more involved in the design
- B. obtaining more contacts
- C. linking at home to do online work
- D. wasting less time
- E. decreasing labour costs

## Section 4

### Questions 31-40

#### Questions 31-32

Complete the sentences below.

Write NO MORE THAN ONE WORD for each answer.

LED is a 31 ..... for light-emitting diode. H. J. Round discovered a 32. .... called electroluminescence.

#### Questions 33-34

Circle TWO letters: A-G.

33 & 34. Which TWO of the following items included the first commercial LEDs?

- A. TVs
- B. electronic test devices
- C. telephones
- D. interior lighting
- E. radios
- F. household appliances
- G. lab equipment

#### Questions 35-40

Complete the diagrams below.

Write NO MORE THAN THREE WORDS for each answer.

A 35. ... of  
semiconducting  
material +  
impurities = a  
p-n-junction

LED

electron flows into  
the junction and  
meets a 36. ...

release energy in the  
form of a photon



37. ... of the  
light is emitted

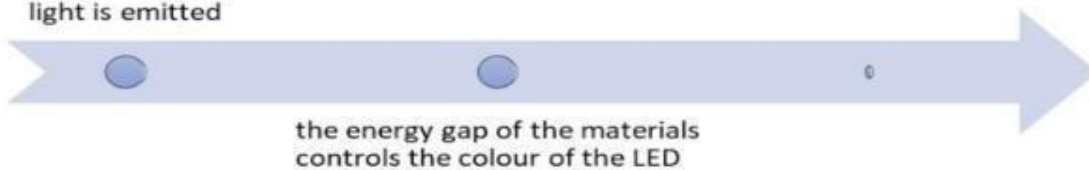

### White LED

resulted from  
**38. ...**

phosphor-based

### Near UV- emitters

used to inspect  
anti-counterfeit  
**39. ....** in  
banknotes

### OLED

based on **40 ...**  
e.g. polymers  
are used in  
producing  
flexible visual  
displays.



# TEST 12

Listen to [audio 12](#) and answer the questions below.

## Section 1

### Questions 1 - 10

Complete the table below.

Write ONE WORD AND/OR A NUMBER for each answer.

#### Notes on A Part-time Society

Example

Name of society: Leighton

Location: 1 ..... house

Want: 2 ..... actors and singers (no experience required)

Transportation: shuttle services (need someone who is able to 3 .....)

Meeting time: 6:00-8:00pm every 4.....

Close time: during 5.....

#### Membership fee (including 6.....)

- £40 for employed members (under 30 years of age)

- £ 60 for employed members (30-60 years of age)

- £ 7..... for retired or unemployed members (over 60 years of age)

#### Minimum joining age

- 8.....

#### Most members are

- friendly

- fond of culture and music

- 9 .....authors looking for new experiences to write about in their books Charity

The children's 10 ..... will get the money raised by the annual dinner.

## Section 2

### Questions 11-20

Complete the table below.

Write NO MORE THAN THREE WORDS for each answer.

Name of Room	Characteristics	Furniture and Features
Entrance Hall Vestibule or Octagon Hall	11. A ..... colour	Chinese style chairs brass enclose
Entrance Hall	12. With... ..... panels of serpents and dragons	furniture looks like pollarded oak

Long Gallery		13..... and Oriental pots
Banqueting Room		A dining table laid for the 14....., with thirty-six chairs
Great Kitchen or King's Kitchen	Four 15. ....	16. A ..... used to turn 5 spits
Music Room	Nine 17. ....	
Yellow Bow Rooms	A lobby Two bedrooms 18. and .....	satinwood and mahogany
Queen's Bedroom	Queen's bedroom Maid's room Closet	Brussels 19 ..... with 20..... bedding and curtains

## Section 3

## Questions 21 - 30

### Questions 21-25

Choose the correct letter, A, B or C.

21. What has Irene recently done?

- A. She has almost finished planning the experiment.
- B. She is not applying herself enough to her work.
- C. She spends a lot of time in the laboratory.

22. What is Bill's attitude toward Kim?

- A. He is grateful for Kim's contribution.
- B. He is not fond of Kim's tastes in clothes.
- C. He thinks Kim is not good at laboratory work.

23. What does Jen think of the other people in the group?

- A. The boys are good at maths which is very helpful.
- B. They would fail the experiment without Irene's contribution.
- C. Irene has completed the data analysis so the experiment is nearly done.

24. How did Jen and Bill feel about Linda?

- A. She was always submitted her work late for the group work.
- B. She was difficult to get in touch with.
- C. She thought it was easy to get a high score.

25. Why was Jen invited to the professor's individual project?

- A. She was quite popular among students.
- B. She always finished reading all the assignments.
- C. She was close to the professor.

### Question 26- 30

Choose FIVE answers from the box and write the correct letter, A-G, next to questions 26-30.

What task has been given to each person?

Tasks

- A. Abstract

- B. Acknowledgement
- C. Methodology
- D. Bibliography
- E. Literature review
- F. Results
- G. Discussion

Person

- 26.Irene .....
- 27.Kim .....
- 28.Jen .....
- 29.Bill .....
- 30.Linda .....

## Section 4

### Questions 31-40

Questions 31-35.

Complete the diagrams below.

#### Cutaneous Pain

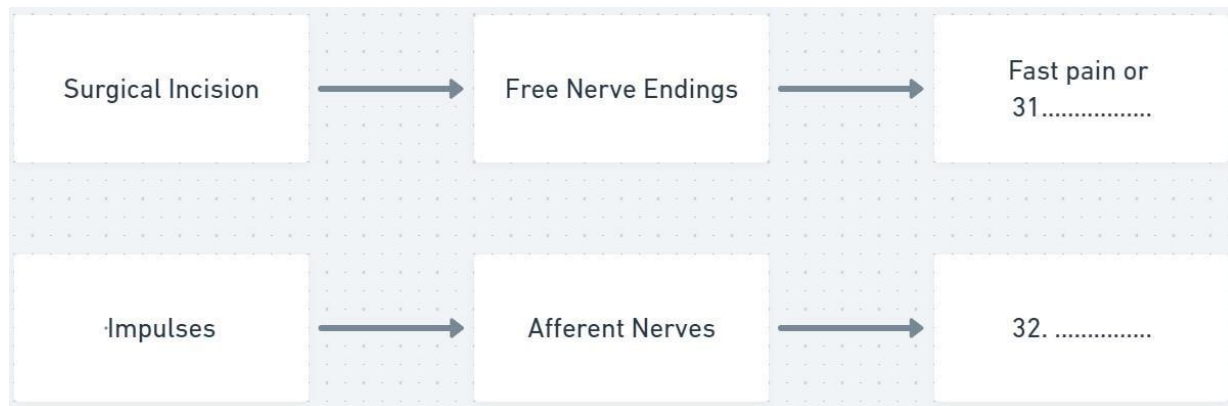

## Visceral Pain

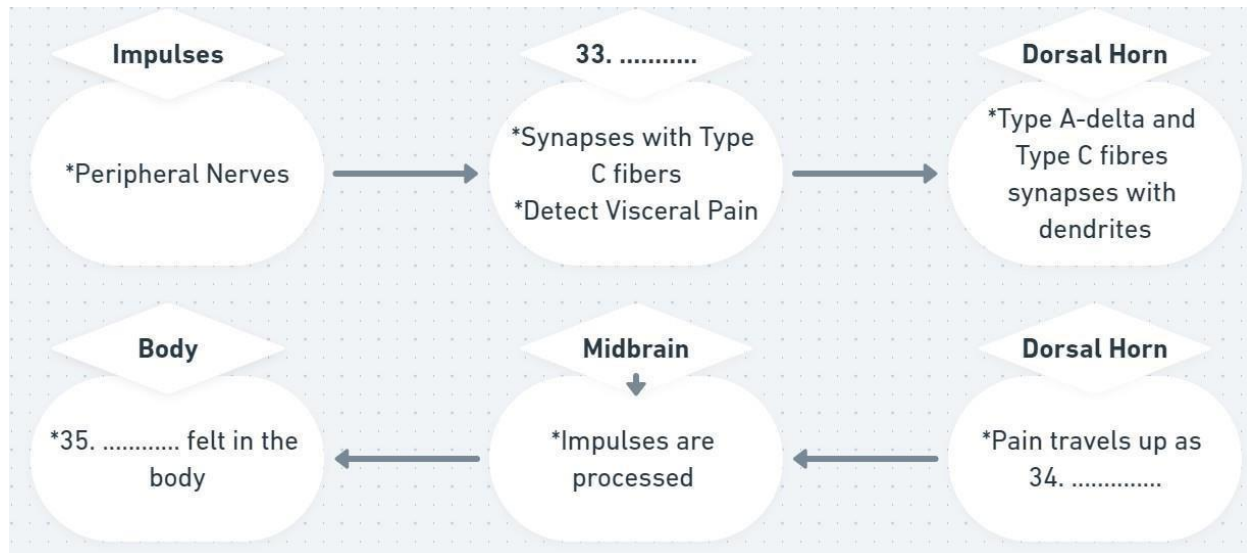

### Question 36

Circle the correct letter A-C.

36. Which of the following is an example of reaching the pain threshold?

- A spilling boiling water
- B burning your hand
- C scalding hot water

### Question 37

Complete the sentence below. Write NO MORE THAN TWO WORDS for your answer.

Pain tolerance refers to 37 .....to pain. Patients should complete a questionnaire known as Pain Scales: Universal Pain Assessment Tool.

### Question 38

Complete the flowchart below. Write NO MORE THAN TWO WORDS for your answer

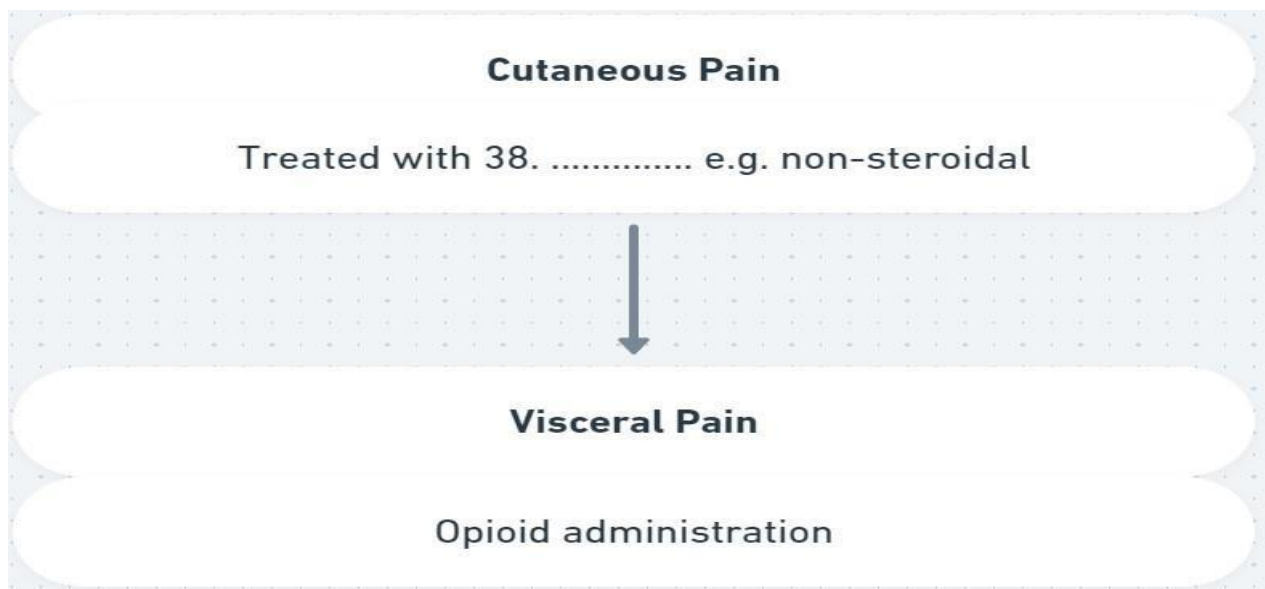

### Questions 39-40

Complete the sentences below. Write NO MORE THAN TWO WORDS or A NUMBER for each answer.

Endorphins are a 39 ..... Their chemical structure is similar to opioids. Pain Management refers to the use of combinations of drugs, e.g. administration of paracetamol and opioids. It decreases the amount of opioids to 40. ....

# TEST 13

Listen to [audio 13](#) and answer the questions below.

## Section 1

### Questions 1 - 10

Complete the notes below. Write NO MORE THAN TWO WORDS AND/OR A NUMBER for each answer.

#### Job Enquiry

Example

- name: Freddie Lea
- location: 1 ..... Island
- Starting date: 2.....
- Age: 17
- Four vacancies for 3.....
- Pay: 5.52 per hour
- Qualities required: the ability to 4.....
- Duties:
  - + Offer table service
  - + Look after 5.....
- Extra advantage: the ability of the candidate to 6.....
- Benefits:
  - + free 7.....
  - + a 8. .... will be provided
- Interview arranged for 9. .... at 10:00 am
- Need to take
  - + a reference letter from employer
  - + a bank statement
  - + the application form with a 10.....

## Section 2



## Questions 11-20

### Questions 11-15

Complete the notes below. Write NO MORE THAN THREE WORDS and/or A NUMBER for each answer.

<b>Green Home</b> Three sections available: 11 ..... <b>groceries</b>	
Baking Potatoes (Kg) Six 12.....	£1.57 £0.60

### Organic Food

Organic courgettes Brussels sprouts	£2.09 13. ....
-------------------------------------	-------------------

### Fair Trade Products -

14..... is destined to the farmers in developing countries

### Laundry Care

You can get a crystal rain & white lily washing powder if you buy two bottles of 15. ....  
softener.

### Questions 16-17

Circle TWO letters A-F.

16 & 17. Which TWO of the following are own-label products?

- A. washing powder
- B. degreaser
- C. plughole
- D. washing-up liquid
- E. oven cleaner
- F. sink cleaner

### Questions 18-19

Circle TWO letters A-F.

18 & 19. Which TWO of the following are given for free in the kitchenware aisle?

- A saucepan with glass lid
- B stainless steel peeler
- C sandwich tin
- D apron and oven glove
- E aluminium foil
- F 12 cup deep bun tray

### **Question 20**

Complete the sentence below.

Write NO MORE THAN THREE WORDS for your answer.

You can get a free corkscrew if you buy a 20. ....

## **Section 3**

### **Questions 21 – 30**

#### **Question 21 – 26**

Choose the correct letter, A, B or C.

21 How could ancient Africans recognize different stars?

- A. by the location of the stars
- B. by the way stars affect each other
- C. by the distance between two stars

22 In which way do the Weyaka people like to deal with their money?

- A. open bank accounts
- B. assist others
- C. lend money to others

23 What do the Africans obtain from their suffering?

- A. ways of protecting their environment
- B. approaches to improving their international status
- C. reasons for conquering drought

24 What are the local people concerned with?

- A. having enough food
- B. getting rid of the disease
- C. going back to their former environment

25 What is the reason for the declining financial condition of the African people?

- A. They find it hard to trade because of the undeveloped transportation system.
- B. They have difficulty in mining minerals.
- C. They refuse to develop a range of commercial activities.

26 When can the African people expect to stop suffering from starvation?

- A. next year
- B. in the long-term future
- C. in the near future

### **Question 27 – 30**

Complete the sentences below.

Write NO MORE THAN TWO WORDS for each answer.

- 27. A valuable quality of the Africans is to make up for the difficulties of food transportation.
- 28. The government intends to pay greater attention to their plan.
- 29. Nowadays, the Africans are encouraged to in an area consistently.
- 30. For the Weyaka people, it is impolite to visit someone's home without.

## **Section 4**

### **Questions 31-40**

#### **Questions 31-34**

Complete the diagrams below.

Write NO MORE THAN TWO WORDS and/or A NUMBER for each answer.

Newton's First Law	Newton's Second Law	Newton's Third Law
<ul style="list-style-type: none"> <li>Inertia is connected with the concept of <b>31. ...</b></li> </ul>	<ul style="list-style-type: none"> <li>Force depends on the object's mass and it is in <b>32. ...</b> to acceleration</li> </ul>	<ul style="list-style-type: none"> <li>It is also named as <b>33. ...</b> law</li> </ul>

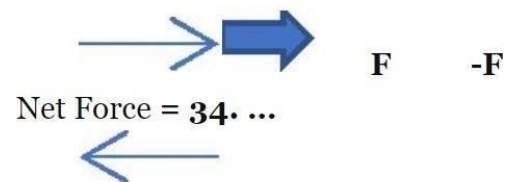

Newton's Third Law



#### Questions 35-40

Complete the table below.

Write NO MORE THAN THREE WORDS for each answer

Physical Force	Further Information	
Equilibrium	Static Equilibrium: objects at rest	
	Dynamic Inertia: 35. ....	
Gravity	Universal force and its 36. .... is $9.81\text{m/s}^2$ .	The acceleration remains the same during 37. ....
Normal	Atoms undergo 38. ....	It keeps the 39.....of an object.
Friction	Static Friction: Force is 40. .... to the surface	
	Kinetic Friction: Independent of forces on the object	

# TEST 14

Listen to [audio 14](#) and answer the questions below.

## Section 1

### Questions 1 - 10

Complete the table below.

Write ONE WORD AND/OR A NUMBER for each answer.

NOTES OF CONCERTS			
Example What to order before the start <u>coffee</u>			

Types of concerts	Time	Cost	Additional information
1... .. concert	Every afternoon	2. \$ ..... For students and \$6.50 for adults	<ul style="list-style-type: none"><li>Organise a press tent</li><li>Broadcast on local 3..... station</li></ul>
4... .. concert	Friday	Entrance fee: Approx \$40	Decorate with 5.....
Opera Show	6 .....	Charged by 7.....	There will be a 8..... Performance
Karaoke Night	Saturday	No group 9.....	To end the show, a popular 10 ..... will perform

## Section 2

## Questions 11-20

Complete the notes below. Write NO MORE THAN TWO WORDS for each answer.

### Seven Sisters' Campsite

Seven sisters are named after 11 ..... in East Sussex

### Weekly Schedule:

#### Monday

- Go on a trail
- Have a picnic next to a 12. ....
- Have a swim PS. Activities are subject to 13 ..... conditions

#### Tuesday

- Continue up the hill Tuesday Continue up the hill
  - Arrive at a 14. ....
  - Go 15. ....
  - Have a pebble massage
- A range of 16 ..... are available there, including jet-skiing and parasailing.

Pieces of  
Equipment:

There are also boats, 17 ..... and kayaks and you can set out to sea as long as you are wearing 18. ....

You can also go rock-climbing and you can go 19. .... when you come back down to earth. You can talk to your friends while you are near an open 20. ....

## Section 3

### Questions 21 – 30

#### Questions 21-25

Choose the correct letter, A, B or C.

21 Students may fail the exam if they

- A. do not collect primary statistics.
- B. copy other people's work.
- C. do not follow the instructions.

22 Why does the man think they should avoid including the pictures of the first volcano in the presentation?

- A. They are not attractive.
- B. The time is limited.
- C. People have never heard of it.

23 About Mount Fago, a volcano in Mexico or the USA, the man thinks

- A. they should not use inaccurate information in the presentation.
- B. they should use another example.
- C. it does not matter where the volcano is.

24 The woman thinks they should mention Mount Etna since

- A. it covers most of the important points.
- B. It was formed a long time ago..
- C. it has stunning views.

25 They agree to leave out Mount Herton as

- A. other students have used it before.
- B. it is irrelevant to their topic.
- C. there is nothing special about this volcano.

### **Question 26 – 30**

Choose FIVE answers from the box and write the correct letter, A-G, next to questions 26-30.

Which statement applies to each of the following situations?

- A. make a short film
- B. lacked his/her own points
- C. neglect the positive aspect
- D. watch some documentaries
- E. did not prepare beforehand
- F. identify the differences between them.

- 26.The woman’s last presentation was criticized because of it  
 27.The tutor suggests for the next presentation the woman should  
 28.People do not know enough about volcanoes and so they  
 29.The reason why the man felt very nervous is that he  
 30.They are researching active and extinct volcanoes to

## Section 4

### Questions 31-40

#### Question 31

Complete the sentence below.

Write NO MORE THAN TWO WORDS for your answer.

Petroleum is a 31 ..... resource as it cannot be replenished.

#### Questions 32-33

Complete the diagram below.

Write NO MORE THAN TWO WORDS for your answer.

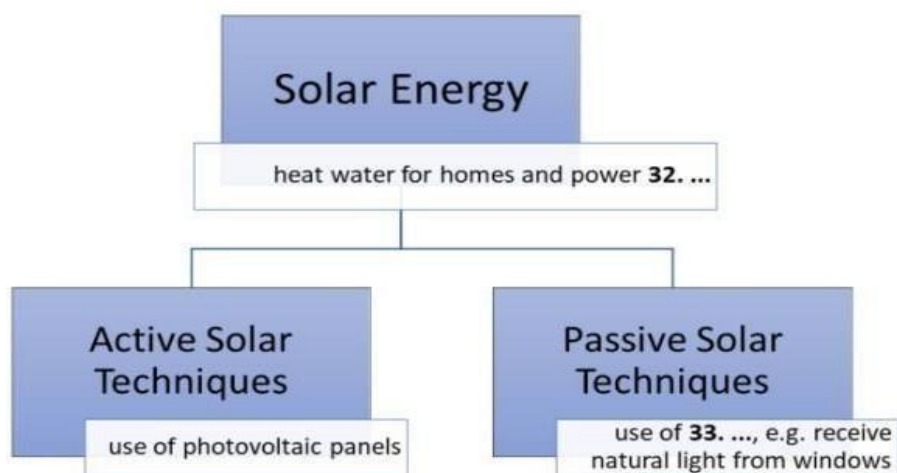

#### Questions 34-40

Complete the table below.

Write NO MORE THAN THREE WORDS for each

answer.

Natural Resource	How it is Generated	Further Information
Biomass	Plants 34 ..... solar energy when they are burnt.	
Wind Energy	Wind turbines produce between 600kW and 5MW of rated power	Wind speeds are higher in 35. ....
Hydropower Energy	Hydroelectric dams	run-of-the-river hydroelectricity derives from 36. ....
Geothermal Energy	Heat is trapped in 37. .... GSHP extracts heat from the ground	86% of the houses in 38. .... were heated by geothermal energy in 2000
Biofuels	Biomass They can be divided into solid biomass, liquid fuels and biogases	Bioethanol is a 39. .... in the USA and Brazil. Biodiesel reduces CO levels in Europe. In 2010, it provided 40. ....of global road transport fuels

# TEST 15

Listen to [audio 15](#) and answer the questions below.

## Section 1

### Questions 1 -10

Complete the notes below. Write ONE WORD AND/OR A NUMBER for each answer.

#### INCIDENT REPORT

##### Example

Name: Anna Lumley

Telephone: 1.....

Date of arrival: 2.....

Address: 235 3 ..... Road, East sea

The total value of insurance: \$ 4.....

Missing items:

- lamps and chairs (not expensive)
- furniture and 5.....
- a rocking horse, some 6. .... and fruit bowls

Items ordered:

- a clock
- a 7.....

Damaged items:

- the 8 ..... needs to be replaced
- a 9. .... of one of the dining chairs are split
- four 10 ..... were broken

## Section 2

### Questions 11-20

Complete the notes below.

Write NO MORE THAN TWO WORDS for each answer.

#### Induction Day – Papyrus Warehouse

Company Identification Card:

- Contains the employee's name, 11 ..... and barcode number
- Done with the HR department
- Used to 12 ..... and out daily

Shop Floor – you need the ID card when you open the till and 13. ....

Stock Room – ID card is also used during the 14. ....

Warning: Don't forget to close the till drawer and 15 ..... of the system.

Staff Restaurant – you can buy snacks if you insert coins into the machines on the 16.

.....

Note: Free lunch is provided on busy days, but the cashier has to 17 ..... your card so that your lunch break is recorded.

#### Personal Belongings:

They should be put in the 18. .... available in the changing rooms. Mobile phones should be switched off.

#### Uniform:

StockRoom – a white shirt and a pair of 19. ....

Shop Floor – a plain shirt and a suit

Note: Women may wear make-up and use 20 ..... as long as it looks neat.

## Section 3

### Questions 21 – 30

#### Question 21 - 25

Choose the correct letter, A, B or C

21 Why did James choose to work in the bakery?

- A. Because it's close to his home.
- B. Because it has a good reputation in the subject area.
- C. Because it's a part of a chain.

22 What was James surprised at in his studies?

- A. He finds the theoretical courses easy.
- B. He can finish the theoretical courses.
- C. He finds the theoretical work interesting.

23 How is James' course assessed in the first term?

- A. The marks are given by students to each other.
- B. Self-assessment.
- C. It is up to the practical experience.

24 Why has Kate enquired about the English language course?

- A. She wants to become an artist.
- B. It is her first language.
- C. She plans to curate in a gallery.

25 What else did Kate need to get before going to college?

- A. starting date of the course
- B. an offer with scholarships
- C. a catalogue of modules

#### Questions 26-30

Choose FIVE answers from the box and write the correct letter, A-G, next to questions 26-30.

What statement applies to each of the following courses?

- A. There are a lot of background readings.
- B. People stay at the studio where the course is taken.
- C. Many outside speakers will give a talk.
- D. It's the most difficult course.
- E. Students do their own research.
- F. Students need to spend a lot of money on a camera with a good display. G. Expensive materials need to be bought.

- 26. History of Art
- 27. Sculpture
- 28. Digital Painting
- 29. Art Theory
- 30. Photography

## Section 4

### Questions 31-40

#### Question 31

Circle the correct letter A-C.

31. Which graph shows an increase in the Earth's temperature in the last 3 decades?

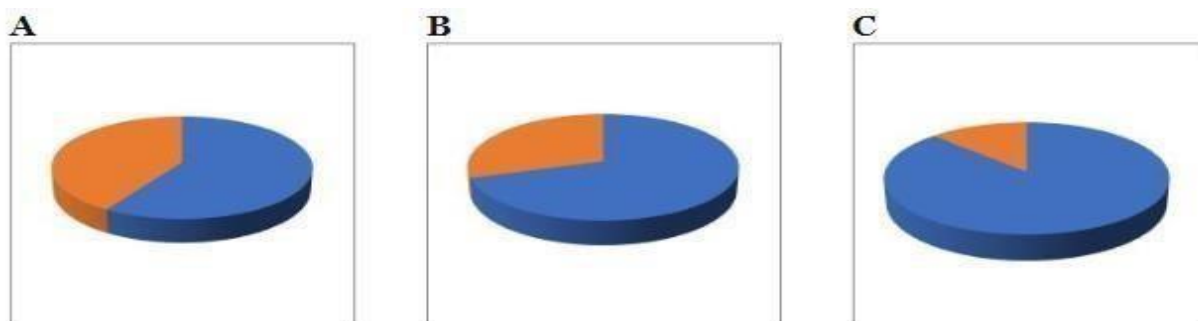

### Questions 32-33

Complete the sentences below. Write NO MORE THAN TWO WORDS for your answer.

Arctic 32 ..... release up to 100 million tonnes of methane gas annually.

Moreover, 25% of all methane is stored on the land surface and it can be released from 33.

.....

### Questions 34-40

Complete the diagrams below.

Write NO MORE THAN THREE WORDS for your answer.

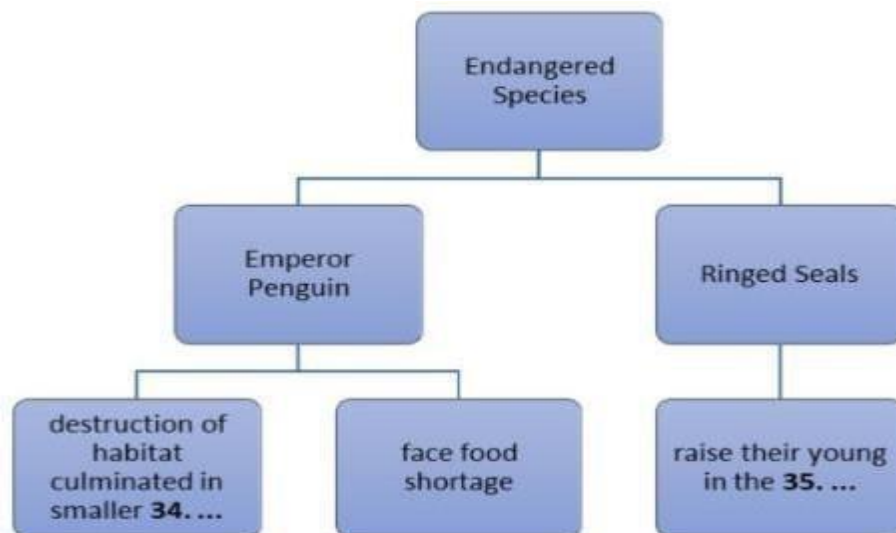

Arctic Fox	<ul style="list-style-type: none"> <li>its habitat was invaded by red foxes</li> </ul>
Beluga Whales	<ul style="list-style-type: none"> <li>human invasion of the area which was 36. ...</li> </ul>
Staghorn Corals	<ul style="list-style-type: none"> <li>suffer from ocean acidification</li> </ul>

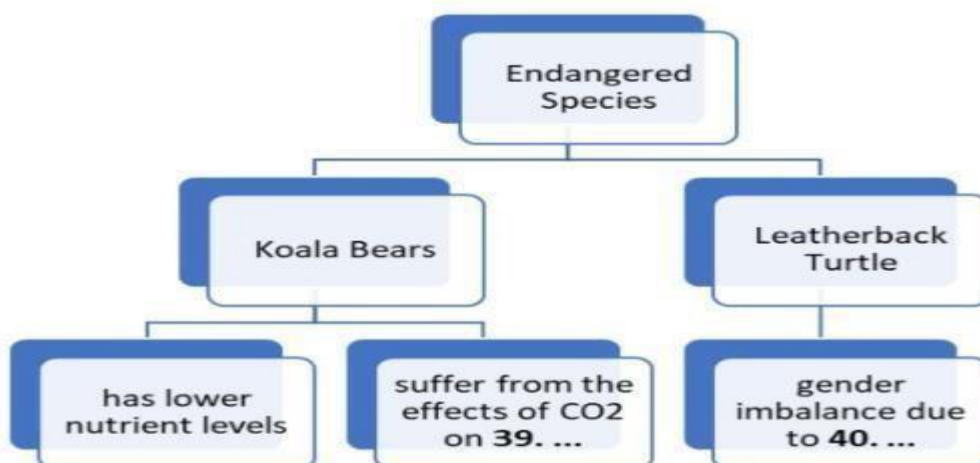
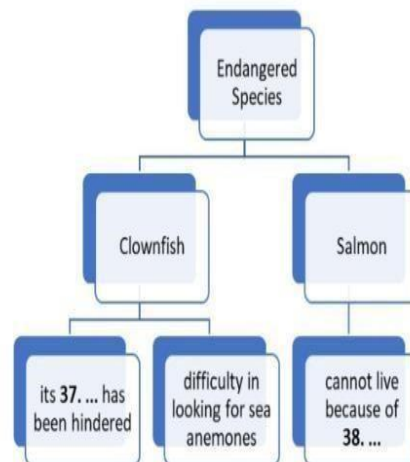

# TEST 16

Listen to [audio 16](#) and answer the questions below.

## Section 1

### Questions 1 - 10

Complete the notes below.

Write **ONE WORD AND/OR A NUMBER** in each gap.

#### Bud and Annie's families

##### Annie's family issues:

- father is in bad mood
- mother's .....1.....is increasing again. She needs surgery to replace her .....2.....
- the operation is very expensive, around \$ .....3.....
- her family is getting problems with .....4..... because sister does not want to help - her sister seems to be selfish after the beauty .....5.....

##### Bud's family issues:

- Annie thought Bud's .....6.....was a nice person but, she turned out to be ...7.....after getting promoted.
- his dad signed a huge .....8..... and looking for some 9.....
- his parents are currently in France for .....10..... Anniversary.

## Section 2

### Questions 11 - 20

#### Questions 11 - 13

Choose **THREE** letters, A-F .

Which **THREE** things that most people want to spend their income on mentioned by the speaker?

- A** people spend the same on enjoyment regardless of age
- B** people usually spend 1,500 pounds per month on necessary things
- C** people tend to spend much more than what they really want
- D** the amount of money spending for the future differs for different people
- E** people tend to spend their income widely on different things
- F** people mainly invest their money for education and a big house

### Questions 14 - 15

Choose TWO letters, A-E .

Which TWO rules should people follow to manage their money mentioned by the speaker?

- A** maximum of 10 percent of the monthly budget is allowed for entertainment and unexpected things
- B** do not spend money on fancy restaurants or drinking
- C** only use cash for essentials like house repairs, birthday present
- D** Only use credit card to buy something for changing money
- E** staying at home when the monthly budget is almost running out

### Principles on money investment

16. Why do people need to keep a current deposit in a bank account?

- A** for some rainy days
- B** for some unexpected cases
- C** for retirement

17. Unused money should invest in

- A** the government lottery.
- B** gambling games.
- C** risk investment.

18. Investing money for higher earning potential, people can

- A** take a higher risk.
- B** make a big fortune in a short period of time.
- C** guarantee to get more money back in every situation.

19. What is a balanced portfolio?

- A** a wide investment list
- B** a steady investment
- C** a refundable investment

20. Investing money wisely means

- A** putting money into different investments.
- B** Spending money on venture capital
- C** spending money on low-risk investments.

## Section 3

### Questions 21 - 30

#### Questions 21 - 23

Choose the correct letters A,B or C

21) Andrew has worked at the hospital for

- A two years.
- B three years.
- C five years.

22) During the course Andrew's employers will pay

- A his fees.
- B his living costs.
- C his salary.

23) The part-time course lasts for

- A one whole year.
- B 18 months.
- C two years.

### Questions 24 and 25

Choose TWO letters A-E.

What TWO types of coursework are required each month on the part-time course?

- A a case study.
- B an essay.
- C a survey.
- D a short report.
- E a study diary.

### Questions 26-30

Complete the summary below.

Write NO MORE THAN THREE WORDS AND/OR A NUMBER for each answer.

### Modular Courses

Students study (26) ..... during each module. A module takes (27) ..... and the work is very (28) ..... To get a Diploma each student has to study (29) ..... and then work on (30) ..... in depth.

## Section 4

### Questions 31 - 40

#### Questions 31 – 35



Write NO MORE THAN three words for each answer

31. According to George Bernard Shaw, men are supposed to understand \_\_\_\_\_, economics and finance.

32. However, women are more prepared to \_\_\_\_\_ about them.

33. Women tend to save for \_\_\_\_\_ and a house.

34. Men tend to save for \_\_\_\_\_ and for retirement.

35. Women who are left alone may have to pay for \_\_\_\_\_ when they are old.

### **Questions 36 – 40**

Complete the summary below.

Write no more than three words and/or a number for each answer.

#### **Saving for the future**

- Most women think about their financial future when a/an 36 \_\_\_\_\_ occurs.

- Women start thinking about 37 \_\_\_\_\_ when they are in their early twenties .

- To develop their 38 \_\_\_\_\_ in dealing with financial affairs would be to attend classes in money 39 \_\_\_\_\_.

- Women should put a high proportion of their savings in low risk investments and the rest for 40 \_\_\_\_\_ ones which can offer them a comfortable, independent retirement.

# TEST 17

Listen to [audio 17](#) and answer the questions below.

## Section 1

### Questions 1 - 10

#### Questions 1 - 6

#### Contact Details on buying a used car

<b>Model:</b>	Celica
<b>Year:</b>	1985
<b>Number of owners:</b>	.....1.....
<b>Condition:</b>	<ul style="list-style-type: none"><li>• overall good.</li><li>• .....2..... were replaced last year</li></ul>
<b>Reason for selling:</b>	moving 3.....
<b>Asking price:</b>	£.....4.....
<b>Appointment time:</b>	.....5.....
<b>Address:</b>	.....6..... St, Parkwood.
<b>Contact name:</b>	Elena

#### Questions 7-10

Circle the correct letter A-C.

7. What happened to Sam's car?

- A. It was replaced by another one.
- B. It broke down.
- C. It was stolen.

8. Why does Jan need a car now?

- A. She lives too far from the university.
- B. She spends too much time on the bus.
- C. She would feel safer at night with a car.

9. What does Sam recommend?

- A. check the service records
- B. avoid buying an old car
- C. get a mechanical inspection

10. How are they travelling to Elena's?

- A. by motorcycle
- B. on foot
- C. by bus

## Section 2

### Questions 11 - 20

#### Questions 11-13

Write NO MORE THAN TWO WORDS in each gap.



### WHALE WATCHING TRIP

11

( PACIFIC NORTH WEST)

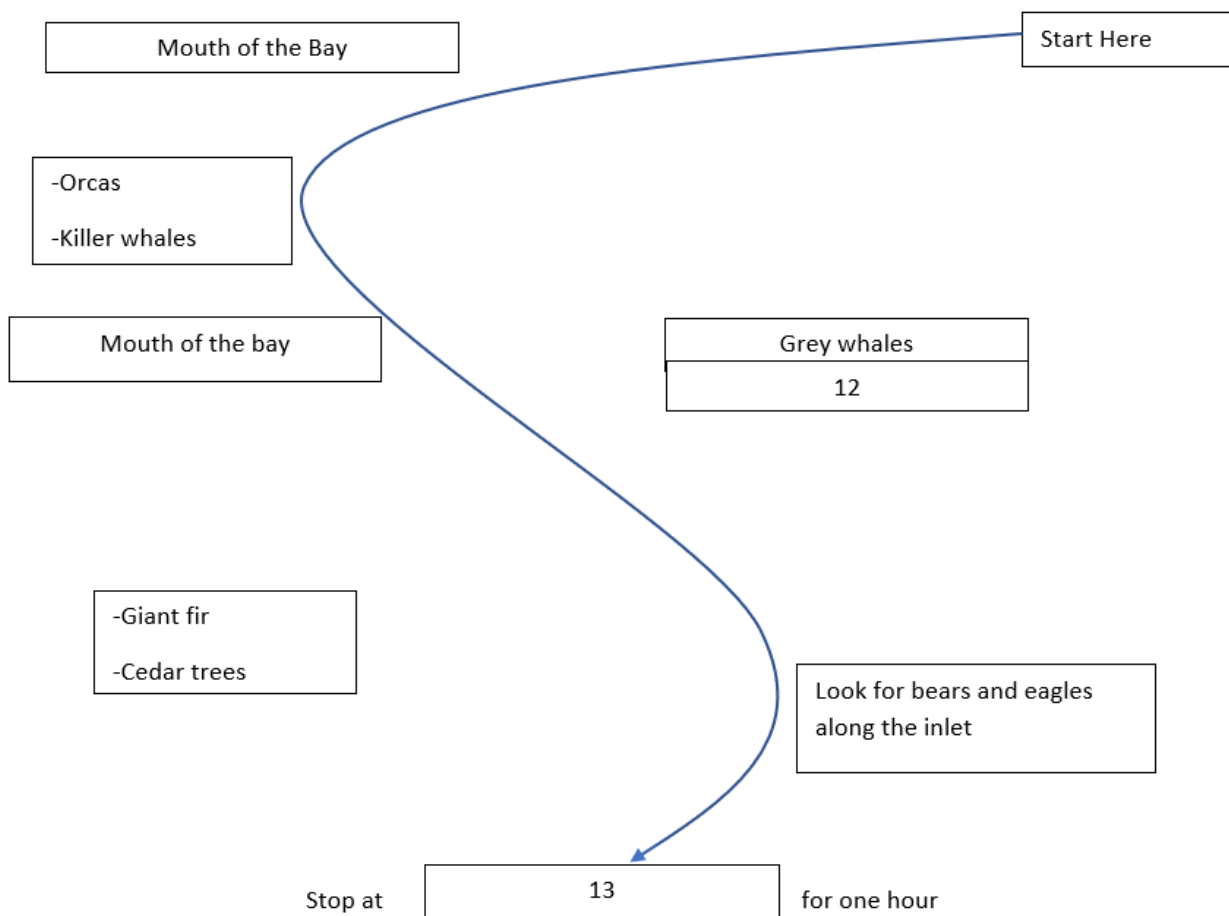

### Questions 14 - 16

Complete the table below

Write **ONE WORD ONLY** in each gap:

### Whale identification chart

	Color	size	General characteristics
Dolphins	Grey	1 - 2 metres	<ul style="list-style-type: none"><li>Swim fast</li><li>Playful</li></ul>

			<ul style="list-style-type: none"> <li>.....14.....</li> </ul>
Orcas & Killer whales	Black and white	7 - 8 metres	<ul style="list-style-type: none"> <li>.....15..... hunters</li> <li>Eat fish, seals and other whales</li> </ul>
Grey whales	Grey	14 metres	<ul style="list-style-type: none"> <li>.....16...</li> <li>Filter feeders, eat shrimp</li> <li>Distinctive tail fins</li> </ul>

### Questions 17 - 20

Write **ONE WORD ONLY** in each gap

#### Advice for Participants on Whale Watching Excursions

- For a smooth ride, sit in the middle near the boat's .....17.....
- Watch the waves and hold onto the .....18.....
- Survival suits are .....19..... in colour for maximum visibility.
- For seasickness: Place a patch on your wrist instead of taking .....20.....

## Section 3

### Questions 21- 30

#### Questions 21-23

Fill in the summary below with **NO MORE THAN TWO WORDS OR A NUMBER** for each space.

#### Selection Process for 'Travel Documentary'

- 34 interviewed from 21..... applicants nationally
- 13 chosen for a 22..... training course in film-making
- 23..... finalists selected as competitors

#### Questions 24-26

- produce a 24..... every two weeks
- no previous professional 25..... experience allowed
- make their own 26..... and obtain approval

#### Questions 27-30

27. What did Sarah Price share about her feelings on the trip last year?

- A      unforgettable memory
- B      pretty exhausting
- C      very exciting

28. What was Sarah Price's worst experience during the trip?
- A She got lost in Mongolia.
  - B She was homesick
  - C She got sick in a remote place.
29. In which of the following areas does Ray expect to have most difficulty?
- A loneliness
  - B time pressure
  - C organisation skills
30. In what month does the journey begin?
- A February
  - B March
  - C April

## Section 4

### Questions 31 - 40

#### Questions 31 - 33

Circle the correct answer A-C.

#### History of technology series

31. What does QWERTY stand for?
- A letters on the top row of the keyboard
  - B the company that made the first typewriter
  - C letters on the home row of the keyboard
32. The first commercial typewriter was developed in ...
- A Germany.
  - B Great Britain.
  - C United States.
33. The purpose of the QWERTY keyboard layout was ...
- A to slow down typing speed.
  - B to prevent keys from sticking.
  - C to reduce typing inefficiency.

#### Questions 34 - 40

Write ONE WORD ONLY in each gap.

### **History of Dvorak keyboard**

In 1932 August Dvorak solved the inefficiency problem by redesigning the .....34..... of the typewriter. He put the most frequently typed,.....35..... on the home row. Using the Dvorak keyboard 70 percent of the .....36.....load can be handled from the home row. In contrast, only 50 words can be typed from the home row on the Qwerty keyboard. Other advantages of the Dvorak keyboard include a 50 percent improvement in .....37..... And a 15-20 percent increase in .....38..... But the most important difference is in finger movement. Typists using the Dvorak keyboard moved their fingers around one .....39.....per day, much shorter than using the Qwerty one. However, the Dvorak keyboard was never adopted as the Qwerty one remains .....40.....

# TEST 18

Listen to [audio 18](#) and answer the questions below.

## Section 1

### Questions 1 - 10

#### Ascot Child Care Centre Enrolment form

##### Personal details

Family name: Cullen

Child's first name: .....1.....

Age: .....2.....

Birthday: .....3.....

Other children in the family: a brother aged .....4.....

Address: .....5.....Rd., Brisbane

Emergency contact number: 3467 8890

Relationship to child: .....6.....

Development

- Has difficulty .....7..... during the day
- Is able to .....8..... herself

Child-care arrangements

Days required: Monday and 9.....

Pick-up time: .....10.....

## Section 2

### Questions 11 – 20

#### Children activities during Holiday

Things to do in the holidays

- Main problem - children do not have a traditional .....11.....

Some ideas

- Give children jobs, for example cleaning the .....12.....
- At home, ask children to help in the .....13.....
- Get children to make .....14..... ahead of time
- Get children involved in community work such as visiting the .....15.....
- Involve older children in long-term .....16..... In your community
- You may get some ideas from the .....17.....
- The local .....18..... is often the best place to find ideas

Things to remember

- Make sure children stay .....19.....
- Children up to the age of .....20..... need to be supervised by an adult

## Section 3

### Questions 21 - 30

#### Questions 21-24

Choose the correct answer A, B or C

21. According to John, what is the main advantage of space exploration?

- A. To supply resources for use on Earth.
- B. To find out more about the origins of our planet.
- C. To establish a colony for humans if Earth becomes uninhabitable.

22. According to the speakers, why can't robots be sent into space instead of humans?

- A. They cannot operate for long enough.
- B. They are too expensive to build.
- C. They are too reliant on humans.

23. What are we told about the space technology currently used?

- A. It can be unreliable.
- B. It is based on old technology.
- C. It is becoming cheaper to produce.

24. What is the biggest problem in sending robots to Mars?

- A. the distance
- B. the atmosphere

C. the extreme temperatures

### Questions 25-30

Who expresses the following opinions?

#### Persons

A John

B Susan

C Both John and Susan

#### Opinions

25. We should plan a trip to Mars even though it may not happen soon.

26. We may eventually colonise Mars.

27. The soil on Mars is highly toxic.

28. The soil on Mars contains materials we could use.

29. Spaceships cannot be totally protected from radiation.

30. It is possible that humans could form a base on Mars.

## Section 4

### Questions 31-40

Complete the notes below using NO MORE THAN TWO WORDS AND/OR A NUMBER.

#### The history of dentistry

##### Early history

The earliest reference to problems with teeth was in 31 \_\_\_\_\_

The ancient Sumerians called problems with teeth 'tooth 32 \_\_\_\_\_

There is 33 \_\_\_\_\_ to show that the Chinese used dental treatments.

##### Remedies and treatment

An old text from 34 \_\_\_\_\_ reveals medical practices from 1700 to 1500 BC. The text refers to the use of 35 \_\_\_\_\_ and 36 \_\_\_\_\_ to relieve toothache.

In the fifth century BC a Greek 37 \_\_\_\_\_ noted the beginnings of specialisation in medicine.

A Greek doctor was the first to 38 \_\_\_\_\_ problem teeth.

In Europe during the 39 \_\_\_\_\_, doctors performed dentistry in people's homes.

A dentist from France is said to have founded 40 \_\_\_\_\_ dentistry.

# TEST 19

Listen to [audio 19](#) and answer the questions below.

## Section 1

### Questions 1 – 10

Complete the form below.

Write NO MORE THAN TWO WORDS AND/OR A NUMBER in each gap.

#### Complaint Record Form

Holiday booked in name of:

Last name: .....1.....  
First name: Andrew  
Address: Flat 4 .....2.....House, Winchester SO2 4ER  
Daytime telephone number: .....3.....  
Booking reference: .....4.....  
Special offer: Yes, from .....5..... company  
Insurance: Yes, had .....6..... policy  
Type of holiday booked: .....7..... break  
Date holiday commenced: .....8.....  
Details of complaint: no .....9..... At station  
a/an .....10..... was missing

## Section 2

### Questions 11 - 20

Questions 11 - 15

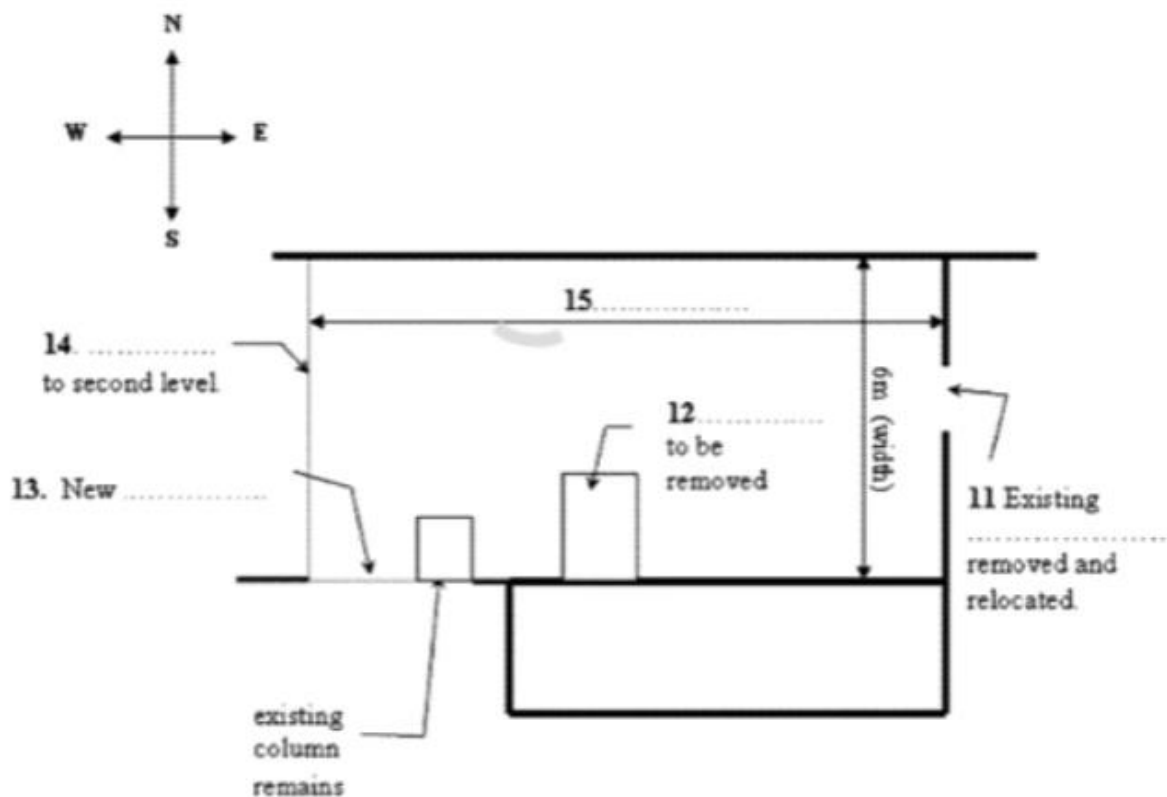

### Questions 16 – 17

Circle the correct letters A, B or C

16. The number of students to be relocated is..

- A. 10
- B. 6
- C. 30

17. The number of students being relocated to each wing is

- A. 10
- B. 6
- C. 30

### Questions 18 – 20

Circle THREE letters A-E. Which THREE of the following changes were mentioned?

- A. new computer desks
- B. study desks

- C. new beds
- D. lamps
- E. painting of rooms
- F. Book shelves
- G. Study chairs

## Section 3

### Questions 21 - 30

#### Questions 21 - 26

Complete the sentences below.

Write **NO MORE THAN THREE WORDS** for each answer.

David feels that progress on the project has been slow because other members of the group are not complying with the 21.....

Jane thinks that personal 22 ..... were not clearly established.

Dr Wilson suggests that the group use the 23.....module available from the Resource Centre.

David doubts that the research will include an adequate consulting 24.....

According to Dr Wilson, the 25..... is now the most important thing to focus on.

Jane believes the group could make more use of some 26.....

#### Questions 27-30

Complete the timetable below.

Choose your answers from the box and unite the letters A-H next to questions 27-30.

- A Compare photographs at newspaper offices.
- B Interview a local historian.
- C Listen to tapes in the die City Library.
- D Study records of shop ownership.
- E Take photographs of the castle area.
- F Talk to the archivist at the City Library.
- G Tour city centre using copies of old maps.
- H Visit an exhibition at the University Library.

**MON - WED: FIELD TRIP TO CAMBRIDGE**

Mon 22nd	am	Arrive at hotel
	pm	27.....
Tue 23rd	am	28.....
	pm	Free time
Wed 24th	am	29.....
	pm	30.....

## Section 4

### Questions 31 - 40

Write ONE WORD only in each gap

#### The Inuit

##### Background

- are the native 31..... of Alaska and Canada
- Migrated across gap between Alaska and Siberia
- Originally came from the continent of 32.....
- The name "Inuit" means "The people"
- Inuit 33..... began years ago
- Norse 34..... Lived near Inuit around 1000 AD

##### Housing

- Inuit worked for 35..... in the 1800s
- well adapted to the Arctic
- in summer: + dwelled in 36.....  
+ traveled in 37.....
- In winter + lived in ice house or 'igloos'  
+ traveled by 38.....
- Took 1- 2 hours to build

##### Food:

- 39..... whales - the main source of food
- polar bears hunted on land

- Constantly looking food
- Major 40.....of Inuit currently located in Alaska and Canada



# TEST 20

Listen to [audio 20](#) and answer the questions below.

## Section 1

### Questions 1 - 10

#### Accommodation request form

Name:	Jenny Chan
Present address:	Sea View Guest House, 1.....Rd
Daytime phone number:	2..... [NB Best time to contact is 9-9:30 ]
Age:	19
Intended length of stay:	3.....
Occupation while in UK:	student
General level of English:	4.....
Preferred location:	in the 5.....
Special diet:	6.....
Other requirements:	- own 7..... - own television - a/an 8..... - to be only guest
Maximum price:	£ .....9..... a week
Preferred starting date:	.....10.....

## Section 2

### Questions 11 - 20

#### Questions 11-13

Complete the sentences below.

Write NO MORE THAN TWO WORDS for each answer.

- The next meeting of the soccer club will be in the .....11..... in King's Park on 2 July.
- The first event is a .....12.....
- At the final dinner, players receive .....13.....

### Questions 14-17

Complete the table below.

Write NO MORE THAN THREE WORDS AND/OR A NUMBER for each answer.

Competition	Number of teams	Games begin	Training session ( In King's park)
14.....	10	15.....	Wednesday afternoons
Senior	16.....	2:30 pm	17..... afternoons

### Questions 18-20

Complete the table below.

Write NO MORE THAN THREE WORDS for each answer.

#### Responsibility

#### Person

- A Manage the club's finance
- B Train the football team
- C Buy new equipments
- D Receive the fees
- E Collect the feedback
- F Deliver newsletters
- G Manage meetings

Gina Cosello: 18.....  
David West: 19.....  
Jason Dokic: 20.....

## Section 3

### Questions 21 - 30

#### Questions 21 - 23

Choose THREE letters, A-F.

Which THREE reasons have Bill and Ann not prepared their presentation in class yet?

- A Bill has been taking care of his mother
- B Ann's neighbors cannot help her with chores
- C Bill spends more time on other things
- D Ann spends more time on her business
- E Bill is too busy with other courses
- F Ann helps her mom with housework

#### Questions 24 - 25

Choose TWO letters, A-E.

Which TWO things are correct about the topic in their class that Bill and Ann have to present?

- A personal characteristics are influenced by uniform
- B wearing a uniform during carrying out experiment in Los Angeles
- C it seems like what Bill read before
- D it is about things to do during summer vacation
- E Problem of wearing a uniform in high school

### Questions 26 - 30

26. Students volunteered in the experiment

- A Had a clue for what will happen
- B were not informed in advance about what will happen.
- C were arrested to a police station.

27. What did the volunteers encounter in the experiment?

- A They did not know that other volunteers had encountered the same thing.
- B They were informed about what they had to wear.
- C They did not know why they had to get charged.

28. In the old experiment, volunteers

- A played a role as arrested persons
- B recognised the experimental purpose.
- C came from different universities.

29. Arrested volunteers in the old experiment

- A were treated like real prisoners.
- B were told to act like prison guards.
- C were not allowed to sleep.

30. What did the volunteers feel during the experiment?

- A The volunteers playing guards with psychological trauma.
- B They all suffered psychological trauma
- C The volunteers playing prisoners with psychological trauma.

## Section 4

### Questions 31 - 40

Complete the notes below.

Write ONLY ONE WORD in each gap.

#### Sales and Marketing

##### Introduction

- advertising is used to make a company successful via different types of 31.....
- advertising 32.....(radio, newspapers, TV, etc.) is not mentioned in this lecture

- 33..... advertising helps to achieve our goals while saving money
- the most common objective of the advertiser is to change customers' behaviour and 34.....

### **Advertising for brands**

- customers tend to buy products from a company as they 35..... their brand name
- promoting a brand is supposed to make customers remember product 36.....
- a famous company with a good brand name could not market successfully other products
- company names usually advertise before their goods and 37.....
- SanFran Video Store 38..... had promoted by handing out flyers
- Chanel is successfully in advertising either company name or products such as 39.....
- it is essential to be mutually 40..... in different types of advertising



# TEST 21

Listen to [audio 21](#) and answer the questions below.

## Section 1

### Questions 1 - 10

Complete the notes below.

Write NO MORE THAN ONE WORD AND/OR A NUMBER in each gap.

#### Apartment Information

Maximum rental: \$....1..... per week  
Minimum period of contract: .....2.....  
Log on the website: www .....3..... .com  
Things included - a circuit .....4..... in all apartments

In the rent: - kitchen equipments:  
+ a/an .....5.....  
+ a/an .....6.....  
- .....7..... bill

Client information:  
Full name: Angela .....8.....  
Address: .....9..... Rd.. Melford MF45JB  
Tel: .....10.....

## Section 2

### Questions 11 - 20

#### Questions 11 - 13

Choose the correct letters A,B or C

11. What is the company's sales figures trend from 2005-2010?

- A Fluctuation, with great increase in the first stage
- B no change during the period
- C great increase during the period

12. What is the relationship of the three departments this year?

- A both Furniture and home appliances are decreased.
- B only apparel is decreased.

C all three departments remain unchanged.

13. Which is the best description about the number trend of temporary staff in the company?

A The trend is the same over the years.

B The trend turns down this year.

C The trend is increasing over the years.

### Questions 14 - 18

Write **NO MORE THAN TWO WORDS** in each gap

#### Parkson Approach to Retail Business

##### Mission Statement

- the drive to .....14.....
- pursuing ways need to be creative and distinctive to fulfill customer's demand

##### Four Priorities

- compelling and distinctive assortments
- .....15.....
- enhanced shopping experience
- .....16.....

##### Magical Special Events

- Thanksgiving Day Parade
- Halloween Fireworks
- celebrity appearances
- .....17.....
- Arrival of Santa Claus
- .....18.....
- animated window displays

### Questions 19 - 20

Choose **TWO** letters. A-E.

Which **TWO** things must be done today?

- A handing in application form
- B reading the brochure
- C submitting certificate
- D applying for staff discount
- E getting security pass

## Section 3

### Questions 21 - 30

#### Questions 21 - 22

Write **ONE WORD ONLY** in each gap

- Art Deco takes its name from a/an .....21..... held in Paris
- Both Art Deco and Art Modern were more often used for 22..... high-rise building blocks.

### Questions 23 - 27

Complete the form below.

Write **ONE WORD ONLY** in each gap

#### Art Deco

- facades with 23..... designs
- Polychromy
- Straight edges and 24..... Shapes
- Vertical emphasis

#### Art modern

- Flat roofed building rooms, curved corners
- smooth walls without 25.....
- more .....26..... than Deco
- .....27..... Emphasis

### Questions 28 - 30

Choose the correct letters A,B or C

28. What do the students want to do in class?
- A showing presentation on photos of buildings
  - B taking class pictures
  - C discussing about how to take the building pictures
29. What do they need to do before taking photos?
- A finding the way to the lobby of the building first
  - B talking to Professor Vargas
  - C asking for permission
30. Who does the woman want to turn to for help?
- A the building manager
  - B building guard
  - C building receptionist

## Section 4

## Questions 31- 40

Write ONE WORD ONLY in each gap

### The Aztec

#### General History

- the Aztec 31..... Existed between the 14th and 16th century
- the capital city of Aztec was in the centre of the 32..... Mexico city

#### Food

- the staple food of Aztecs was 33..... Which has been domesticated for thousands of years, and spread to the rest of the world from Mexico.
- the Aztecs also had other diet such as 34....., squash

#### Clothing

- the clothing of the Aztec was diverse based on different 35..... community
- Aztec clothes were generally made of imported cotton or ayate fiber
- the Aztecs were able to create beautiful colors using a lot of 36.....

#### Education

- girls were instructed about cooking, caring for a family, 37..... and ways to economically run the home
- boys, however, learned trades, fighting and 38..... Skills

#### Region

- the Aztecs went to 39..... to send their tribute and pray
- The tribute included not only agricultural but also rare and 40..... products

# TEST 22

Listen to [audio 22](#) and answer the questions below.

## Section 1

### Question 1-10

#### Questions 1-4

Choose the correct letters A, B or C.

1. Currently, the man is studying

- A. Business
- B. Education
- C. Maths

2. The man wants to study

- A. Education
- B. Business
- C. Accounting

3. When are the Registration Packs available for first-year students?

- A. November
- B. September
- C. December

4. To complete the registration process, the student has

- A. One-month
- B. Two months
- C. Three months

#### Questions 5-7

Complete the form below.

Write NO MORE THAN TWO WORDS AND/OR A NUMBER for each answer.

REQUEST FOR INFORMATION	
NAME	Richard Dreyfus
ADDRESS	5. Unit 12 ..... Avenue, Mermaid Beach, 4554
TELEPHONE	6. ....
EMAIL	7. dreyfus@.....

### Questions 8-10

Choose THREE letters A-F

Which THREE ways to register are mentioned?

- A. by email
- B. by mail
- C. by phone
- D. in person
- E. text message
- F. by facsimile

## Section 2

### Questions 11 - 20

#### Questions 11-16

Complete the sentences below. Write NO MORE THAN TWO WORDS for each answer.

#### The Hotel

- You must book 11..... in advance.
- There are some interesting 12..... in the lounge.

#### Activities

- The visit to the 13..... has been cancelled.
- There will be a talk about 14..... from the area on Saturday.
- The visit to the 15..... will take place on Sunday.
- There is a collection of 16..... in the art gallery.

#### Questions 17-20

Label the map below. Write the correct letter A-I next to questions 17-20.

Where are the following places situated ?

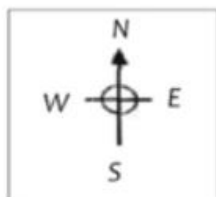

- ( 17 ) Park Hotel .....  
 ( 18 ) Internet Cafe .....  
 ( 19 ) Tourist Information Office .....  
 ( 20 ) Royal House Restaurant .....

## Section 3

### Questions 21 - 30

#### Questions 21 and 22

Choose TWO letters A-E.

What two suggestions does Gloria give to Paul?

- A talk with past graduates
- B chooses from Science, Maths or English
- C study subjects that he naturally likes
- D consult the university handbook
- E go to the office of Academic Affairs

#### Questions 23-27

Complete the table below.

Write NO MORE THAN THREE WORDS OR A NUMBER for each answer.

Title	Author	Year published	Publisher
-------	--------	----------------	-----------

What should I do?	Smith,P	2000	23.....
24.....	Newton,J	2000	25.....
26.....	White,J	27.....	Brown and Tate

### Questions 28 – 30

Choose THREE letters A – F

Which THREE points helped Gloria to Choose her course

- A she spoke with her parents
- B she talked with friends
- C she looked at jobs that were available
- D she researched typical working hours
- E she liked mathematics
- F she liked working with people

## Section 4

### Questions 31 - 40

Write **ONE WORD ONLY** in each gap.

Type of writing	Notes	Tips
Short stories	three basic styles	Start with a/an 31.....
Non-fiction	biographies often popular	Tells publishers about your field of 32.....
Articles	advice articles work well	Write for a definite 33.....
Poetry	meaning shouldn't be too 34 .....	Read your poems aloud
Plays	movements usually decided by the 35.....	Learn about acting
Radio	BBC published handbook	Try 36..... stations first
Children's Literature	Illustrations important	Decide on an age 37.....

38. What is a disadvantage of first person narration in novels?
- A It makes it harder for the main character to be interesting.
  - B It is difficult for beginners to do well.
  - C It limits what can be described.
39. What is a mistake when writing novels?
- A failing to include, enough detail
  - B trying to explain ironic effects
  - C including too many characters
40. In order to make dialogue seem natural, writers should
- A Writers should make recordings of real conversations.
  - B include unfinished sentences
  - C break up long speeches



# TEST 23

Listen to [audio 23](#) and answer the questions below.

## Section 1

### Questions 1 - 10

Write NO MORE THAN ONE WORD AND/OR A NUMBER in each gap.

#### Finnegan's Flight Centre

- Flight info:**
- from Hong Kong to Singapore on 25 July
  - it takes approximately 3 hours 1..... Minutes
  - the passenger should check in before .....2.....
  - the passenger cannot change their flight dates because of work .....3...
  - the passenger will fly back to Hong Kong on ....4.....
  - the passenger wants to .....5..... as soon as she gets back

**Other information:**

- Bert will .....6..... the confirmation details to the passenger
- the maximum weight for .....7..... Luggage is 10kg
- the passenger will check in one .....8..... at extra cost
- the reservation number is .....9.....
- the passenger is for a seat next to the .....10.....

## Section 2

### Questions 11 - 20

#### Questions 11-15

Complete the sentences below. Write NO MORE THAN TWO WORDS for each answer.

- Many 11..... happen around cars.
- Night time travel on 12..... should be avoided.
- In the event of a break-down in a lonely place, wait in the car for help from a police car or another 13.....
- When being followed, if there is no police station nearby, find an open garage or store or go straight to an 14.....
- The police station is located on the .....15..... Between the canal street and the cockleshell court

#### Questions 16-20

Match the toxic gases in the box to the effects below.

Choose your answers from the box and write the letters A-E next to questions 16-20.

### List of toxic gases

- A carbon dioxide
- B nitrogen oxide
- C carbon monoxide
- D hydrogen sulphide
- E Low oxygen air

### List of effects

- 16. People suffer mental impairment
- 17. It hurts the lungs
- 18. It makes you breathe faster
- 19. You cannot see it or smell it
- 20. It numbs the respiratory tract

## Section 3

### Questions 21 – 30

#### Questions 21 - 25

Write NO MORE THAN ONE WORD in each gap

### New Zealand Government System

- New Zealand system of government = a constitutional .....21.....
- Elected House of Representatives = Parliament
- Queen's representative – Governor .....22.....

#### Questions 23 – 25

Complete the flow chart below:

Write **ONE WORD ONLY** in each gap

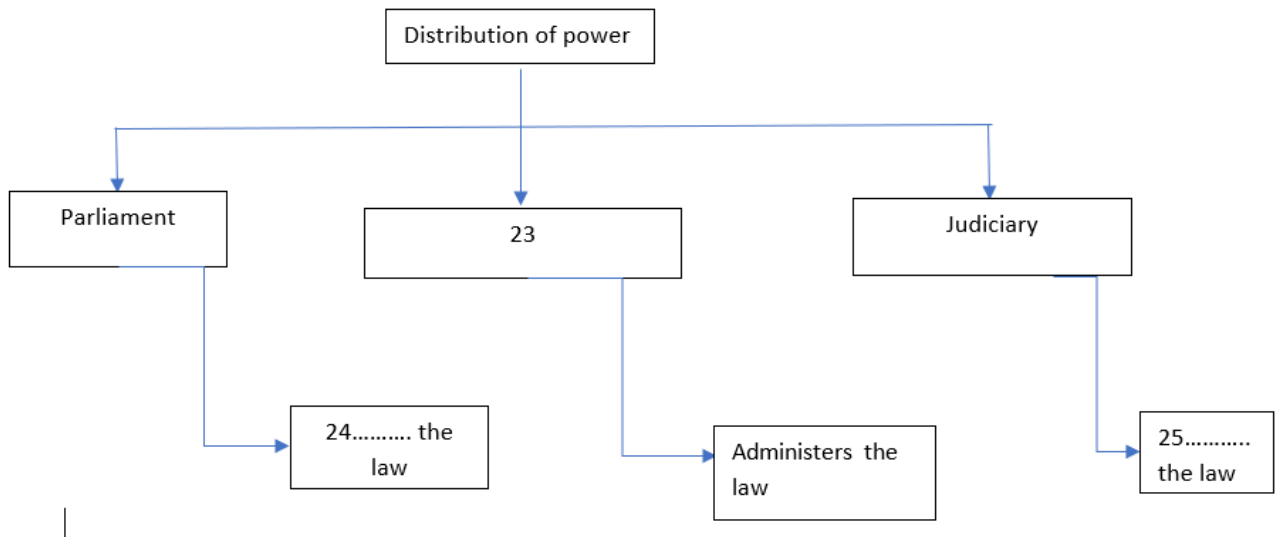

### Questions 26 - 30

Choose the correct letters A,B or C

26. A constitution containing rules for governing is

- A a written document.
- B still a controversial form.
- C an issue passed by Parliament.

27. New Zealand has some unwritten

- A constitutions.
- B simple laws.
- C conventions.

28. A parliament with only one chamber is called

- A House of Representatives.
- B Upper House.
- C Unicameral.

29. New Zealand's voting system is known as

- A Member of Political Party.
- B Member Proportional Representation.
- C Member of Parliament Representatives.

30. Political parties are represented proportionally in parliament according to

- A the share of votes gained in the election.
- B the share of votes in preferred political party.
- C the share of votes in every party

## Section 4

### Questions 31 - 40

#### Questions 31 - 36

Which of the following descriptions is appropriate for the hat color below?  
Choose SIX answers from the list below and write the correct letter A-F , next to Questions 31-36.

#### List of hat color

- A Black
- B Blue
- C Green
- D Red
- E White
- F Yellow

#### List of description

- A creative response - be inventive:
- An emotional response - use intuition:
- A managerial response - like control:
- An optimistic response - be encouraging:
- A pessimistic response - be wary:
- A rational response - focus on data:

#### Questions 37 - 40

Write NO MORE THAN TWO WORDS in each gap



## The stepladder technique

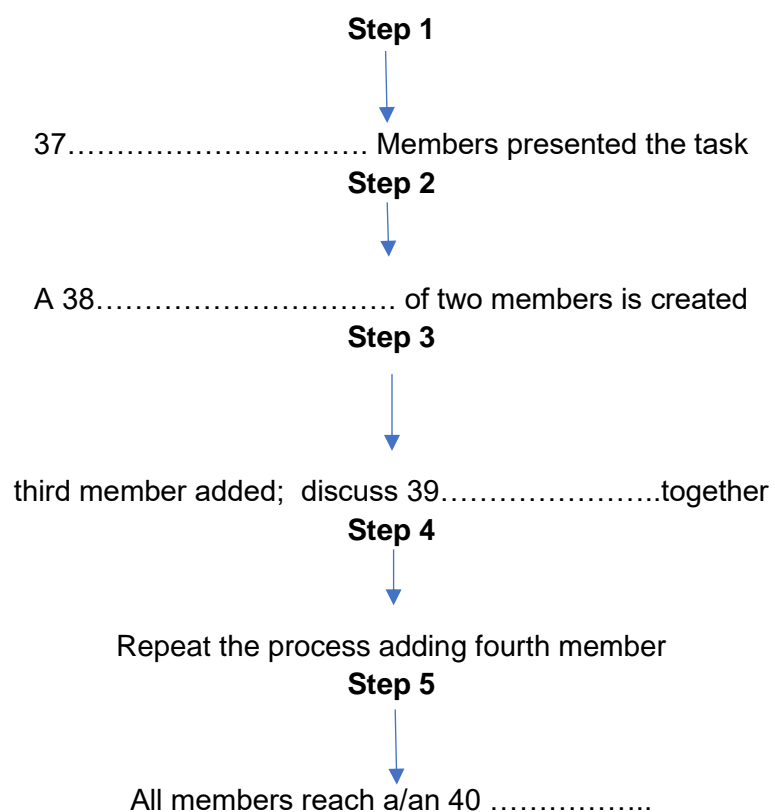

# TEST 24

Listen to [audio 24](#) and answer the questions below.

## Section 1

### Questions 1 - 10

#### Notes on Adult education Classes

- Number of classes: 7 per week
- Tuesday:
- .....1.....(6- 7:30 PM)
  - + limited space: no more than .....2..... Participants
  - Book Club
  - + must read .....3..... Books
  - .....4..... Group
  - + learn about local events last century
- Wednesday:
- Scrabble club ( 2 - .....5.....)
  - + Popular
- Thursday:
- Chess night
  - + serious
  - .....6.....
    - For special occasions
- Adult learners' Week:
- no cost but must make .....7.....
  - + September 1 - 8
  - Techno Expo
  - + learn how to use .....8..... tools
  - + learn about online security issues and online entertainment
  - + Monday, 1 - 4: 30 pm
    - .....9.....
  - + consider values
  - + learn how to attain harmony
  - + Wednesday, 1 - 4.30 pm
  - Venue: .....10.....

## Section 2

### Questions 11 - 20

#### Questions 11-14

Choose the correct letter.

(11) Most infants are hurt

- A at the supermarket.
- B at home.
- C in car accidents.

(12) Children should learn good safety habits from

- A their pre-school teachers.
- B television programs.
- C their parents.

(13) Why are kitchens more dangerous for infants than adults ?

- A They may get stood on.
- B They may get burnt.
- C They may cut themselves.

(14) Poisons should never be kept

- A in glass drink bottles.
- B within reach of adults.
- C in their original containers.

#### Questions 15-16

Which TWO items of playground equipment pose the most danger for children ?

- A Roundabouts
- B Slides
- C Swings
- D Seesaws
- E Climbing frames

#### Questions 17-20

Complete the information below.

Write NO MORE THAN THREE WORDS for each answer.

- If you are bathing the baby, let the phone .....17.....
- If you can install protective .....18.....to stop a child from poking things into a powerpoint.
- The parent should go .....19..... to smoke a cigarette
- The parents shouldn't leave infants alone in a room with .....20.....

## Section 3

### Questions 21 - 30

#### Questions 21 - 26

Complete the summary below.

Write NO MORE THAN TWO WORDS in each gap.

#### Habitat on Wetlands

A wetland is an area where the soil is typically water-logged. Plants and animals living there depend on the wetness for their 21..... Draining swamps is a widespread occurrence which kills off wildlife and, consequently, wetlands are 22..... worldwide. It is a feature of wetlands that conditions vary according to 23..... Water-tolerant plants grow both in and out of the water and water - levels are usually quite 24..... Wetlands naturally occur between land and water and become 25..... for various wildlife during very dry periods. They also act as nurseries for different kinds of animal life. Wetlands are known to upgrade the water's 26..... by removing pollutants.

#### Questions 27 - 30

Complete the diagram below

The process diagram has four gaps. Choose the correct letter, A - H. and move it into the suitable place.

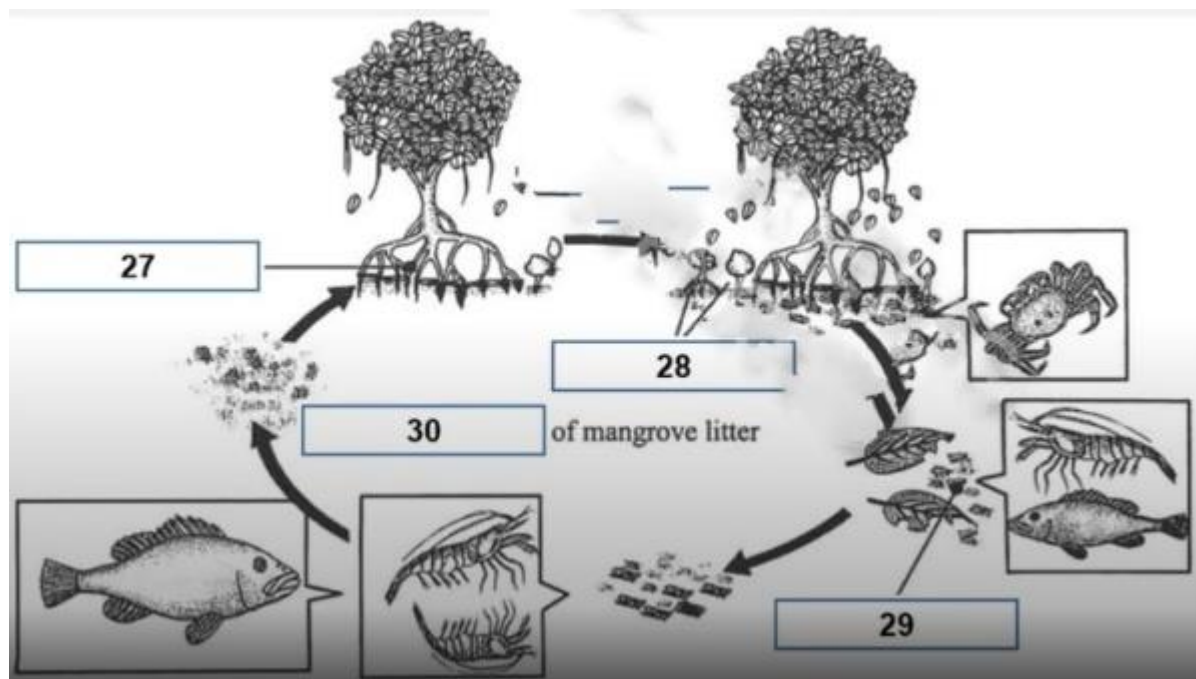

- A ecosystems
- B Green leaves
- C Decomposed litter
- D Nourishment cycle
- E Seedlings
- F Roots in the air
- G Aerial stems
- H Tree seeds

## Section 4

### Questions 31 - 40

Write **ONE WORD ONLY** in each gap.

#### Meteorology

- Elements which produce weather:
  - + 31.....
  - + troposphere
  - + water vapour
  - + 32.....
- Different types of cloud formation:
  - + cumulus is a low cloud layer with white color and 33..... shape
  - + stratus is a grey cloud with 34..... appearance
  - + 35..... is considered as ground clouds
  - + Cirrus is a high cloud layer with wispy, 36..... shape
  - + cumulonimbus is the highest cloud layer, connected to the troposphere to 37..... hailstones, heavy rain, tornadoes, etc.

- Old assumption: large dust particles → bigger 38.....→ more rain
- New research: more dust -----> less rain (because water too dispersed to form 39.....)
- Conclusion: loss of topsoil in nearby areas → progressive 40..... of deserts



# TEST 25

Listen to [audio 25](#) and answer the questions below.

## Section 1

### Questions 1 - 10

#### Questions 1-6

Complete the notes below. Write **NO MORE THAN ONE WORD AND/ OR A NUMBER** for each answer.

#### Small claims tribunal – Claim form

Claimant's name: Emily-Jane Appleby

Address: 1 Yeronga Street, (1).....

Postcode: 4105

Telephone No. (home): (2).....

Respondent: (3).....

Company name: ABC appliances ltd

Address: (4)..... avenue, Bardon

Postcode: (5).....

Telephone no. (work): 72324681

Date (of transaction): 3rd Feb, 2011

Guarantee: (6).....

#### Questions 7-10

Complete the notes below. Write **NO MORE THAN TWO WORDS AND/ OR A NUMBER** for each answer.

#### Details of the claim:

Goods: (7).....  
– ('Mallard' brand, 'Whisper' model, serial no. XY303)

Agreed to pay: (8) ..... pounds

Advantages: - Uses less energy because it has shorter cycle  
- Reduces the amount of (9)..... used  
- Whisper quiet

Complaint: - the cycle is longer and the appliance is very (10).....

## Section 2

### Questions 11-20

Complete the table below.

Write NO MORE THAN TWO WORDS AND/OR A NUMBER for each answer.

- The coach is comfortable because it is .....11.....
- After all passengers are aboard, the coach will make its first stop at ...12..... Island.
- The 'Tree Top Walk' is above a .....13.....
- Passengers will have a .....14..... with the alpacas before boarding the bus for home.

DREAMTIME TOURS			
Bookings at <b>15</b> ..... or Tel: 0755624402			
<b>16</b> ..... TOUR			
SUNDAY, MONDAY, FRIDAY			
Cost		FULL DAY TOUR 280Km DEPARTS:	
Adult	\$37.00	Coolangatta	7.50 am
<b>17</b> .....	\$33 00	Burleigh	8.10 am
Child	\$10.00	Surfers Paradise	<b>18</b> .....
(4-14 years)		Labrador	8.45 am
Family	\$94.00 (2 Adult. 2 Children)		
Prices Include <b>19</b> ..... only			
Free pick-up from your resort, hotel or motel			
* Not included in the fare: Optional tours, luncheons, morning and afternoon tea (unless otherwise specified), <b>20</b> .....			
Meals and refreshments are available at all stops (at your own cost).			

## Section 3

### Questions 21 - 30

#### Questions 21 - 25

Choose the correct letters. A, B or C.

21. According to the liaison officer volunteers help

- A improve language program.
- B provide quality education.
- C staff members in education system.

22. Volunteers help students check and correct

- A written responses.
- B assignments.
- C presentation reports

23. What aspect of students' self-management can volunteers assist greatly with improving?

- A organizational skills
- B problem-solving skills
- C Independent thinking skills

24. What will volunteers try to develop in the students so that they exert themselves more?

- A strong determinations
- B enthusiasm for personal work
- C hard work and diligence

25. What is it that teachers have that allows them to respond to individual student requirements?

- A exchange of information and skills
- B many different teaching styles
- C partnerships between teachers

### Questions 26 - 30

Which of the following phrases is appropriate for the contents below?

Choose FIVE answers from the below and write the correct letter. A-H next to Questions 26-30.

#### List of phrases

- A vocational learning experiences
- B practical components
- C self-learning software
- D academic background
- E marine studies
- F interesting developments
- G scholastic competitions
- H building and construction

#### List of contents

- Sharon and Lester have different: .....26.....
- Sharon and Lester help students': .....27.....
- The program is well underway: ....28.....
- The liaison officer is impressed by: ....29.....
- Students are encouraged to take part in: ..30....

## Section 4

### Questions 31 - 40

#### Anxiety

##### General information

- someone in an anxiety state has worse anxiety 31..... than normal
- a phobia may stem from heredity or 32..... problems
- The reason for the final breakdown is generally linked with 33.....
- occurrences like the loss of a loved one or a health crisis

##### Phobic states

- **Agoraphobia:** fears leaving the home 34.....
- **Claustrophobia:** fears small 35.....
- **Social phobia:**
  - + feels extremely shy in the 36..... of people
  - + becomes.....37.....in front of other people
  - + gets sweaty.....38.....of the body
  - + has a deep-seated .....39.....to a particular creatures (eg: Dogs, cats, spiders etc)
  - + fears of the.....40.....

# TEST 26

Listen to [audio 26](#) and answer the questions below.

## Section 1

### Questions 1 – 10

#### Questions 1 - 6

#### Membership Application Form

Membership time: 7 years  
Type of ID: .....1.....  
ID No.: .....2.....  
Family name: Black  
Other name: Gavin Raymond  
Date of birth: January 22, 1973  
ID expiry date: .....3....., 2012  
Address: .....4.....St, Meadowbank  
Class of vehicle: .....5.....  
Endorsements: None  
  
Convictions: .....6..... (1993)

#### Questions 7 - 10

Complete the table below

Write NO MORE THAN TWO WORDS AND/OR A NUMBER in each gap.

Type	...7.....	Bronze	Silver	Gold
Standard care		5% discount	7.55 discount	50% discount off .....8.....
Insurance		\$10 off fee	\$20 off fee	Free .....9.....
Personal loans	0.25% reduction	0.5% reduction	.....10..... reduction	1.25% reduction

## Section 2

## Questions 11 - 20

### Questions 11 - 16

Choose the correct letters A, B or C

11. Diners can be served inside the restaurant or

- A in the courtyard.
- B in the gardens.
- C in the terrace.

12. Visitors can put on their swimsuits in order to

- A play on the beach
- B swim on the beach
- C play in the water spray areas.

13. The Cottage houses a museum,

- A A cinema room and information centre.
- B information centre and homestead model.
- C homestead model and cinema room.

14. The Garden Nursery is the place to buy

- A handicrafts and statues
- B Garden sculptures and ornaments.
- C handmade souvenirs and pots.

15. The Wood Crafting Shed is a great place to buy

- A Garden accessories and wooden products.
- B wooden products and toys
- C Toys and garden accessories

16. The avocado fruit at Summerland is picked by

- A machine.
- B hand.
- C both machine and hand.

### Questions 17 -20

The map has four gaps. Choose the correct letter A- H and move it into the suitable gap.

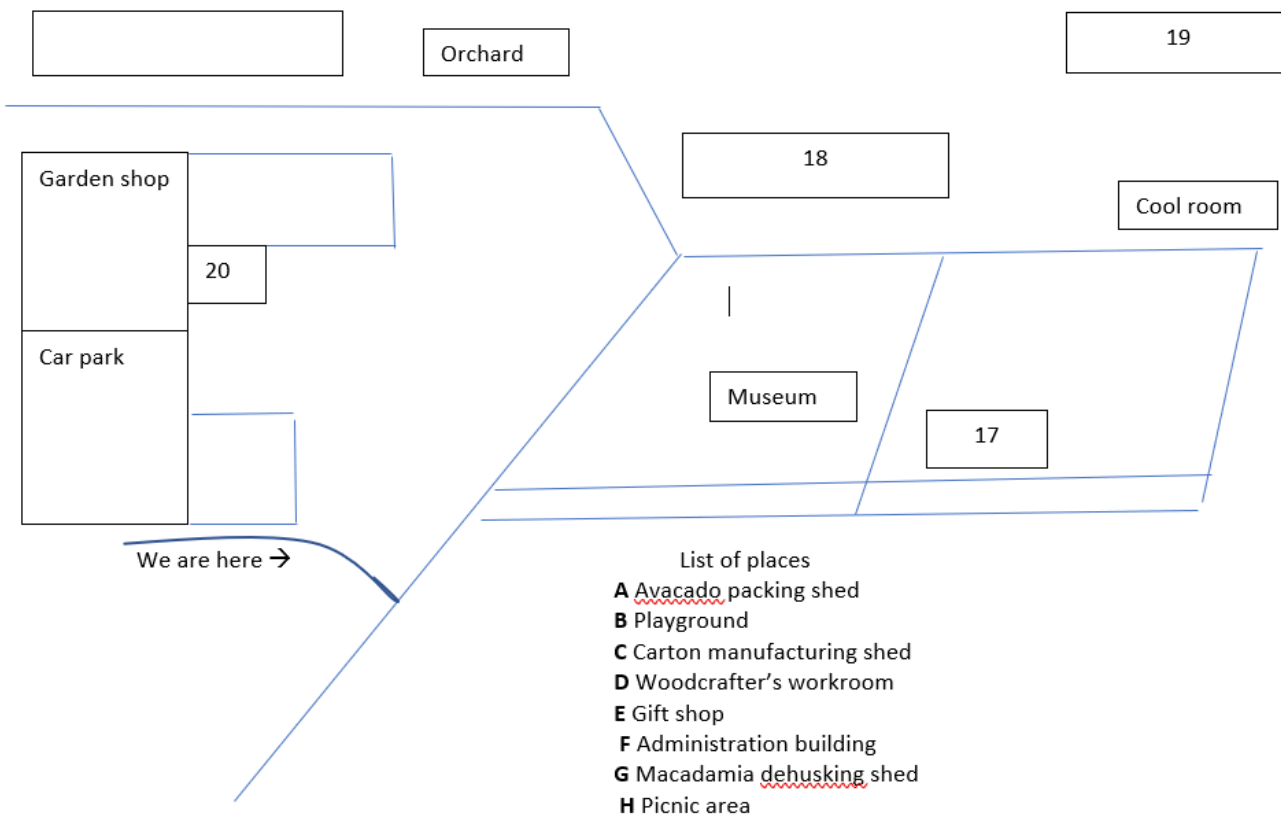

## Section 3

### Questions 21 - 30

#### Questions 21 - 25

Write **ONE WORD ONLY** in each gap.

- In hydroculture, plants are grown with their roots in water so 21.....is necessary for the upper part of the plant.
- LECA is made from 22.....
- The plant would get through the 23.....by making a hole in it.
- The plants are then nourished with a nutrient 24.....in a container
- A layer of litter is supported by a rigid 25.....

#### Questions 26 - 27

Choose TWO letters A- E

Which TWO kinds of products are especially suited to the nutrient film technique?

- A peas
- B beans
- C potatoes
- D yams
- E tomatoes

### Questions 28 - 30

Choose THREE letters A- F

Which of the THREE following things correctly describes a substratum?

- A potential failure in changing system
- B only adaptable to innovative equipments
- C Mineral wool
- D rock
- E paper fibre

## Section 4

### Questions 31- 40

#### The Grand Old Duke of Newyork

General background of Frederick

- Frederick was the same of the duke made famous in a well-known 31.....
- Frederick was aged 32..... when he was sent to war
- his battles against the 33..... ended in total disaster
- In 1798, George III gave his son as a/an 34..... with the ranks of the military
- Frederick should not be held wholly accountable for failing: the 35..... of his fighters made victory difficult to achieve
- the people Frederick commanded were mostly old men, new conscripts or 36.....

The Duke of York

- wanted to enlist better types of 37.....
- made the army better by bringing in chaplains, medics, and veterinary 38.....
- established a college for preparing army 39.....
- Gave up the position of Commander-in-Chief in 1807 because of a 40.....

# SOLUTION

## Test 1

### Section 1

1. Classic
2. Jonathan
3. January 21st
4. island
5. 1
6. Queen
7. 02046751222
8. tutor
9. mother
10. 1000

### Section 2

11. C
12. B
13. A
14. A
15. Gardening art
16. pear
17. watermill
18. refreshments
19. River cotton
20. Strawberries

### Section 3

21. London museum
22. Telephone interviews
23. 90 people
24. Ceramic
25. Peru
26. Surface

- 27. Local clay
- 28. Dried
- 29. Sorting
- 30. The rich people

#### **Section 4**

- 31. C
- 32. A
- 33. A
- 34. B
- 35. C
- 36. A
- 37. A
- 38. B
- 39. B
- 40. D

## **Test 2**

#### **Section 1**

- 1. unfriendly
- 2. noisy
- 3. 23.50
- 4. insects
- 5. bathrooms
- 6. party
- 7. shadforth
- 8. towel
- 9. breakfast
- 10. Kitchen

#### **Section 2**

- 11. B
- 12. A
- 13. C
- 14. B
- 15. A
- 16. A
- 17. E
- 18. C
- 19. F



20. A

### **Section 3**

21. A

22. B

23. A

24. B

25. A

26. A

27. Background

28. Theory

29. Cost (s)

30. Time

### **Section 4**

31. religion(s)

32. nature

33. flight

34. stars

35. practical

36. education

37. king

38. entertainment

39. opera

40. electricity

## **Test 3**

### **Section 1**

1. 3000 words

2. surprising

3. 16

4. 1st August

5. Comp4ss

6. Post

7. Authors

8. Online

9. Public

10. Spain

## **Section 2**

- 11. Water
- 12. Ride
- 13. Noon
- 14. Sharks
- 15. Birthday
- 16. Government
- 17. Quiz
- 18. E
- 19. C
- 20. B

## **Section 3**

- 21. D
- 22. B
- 23. math(s)
- 24. Theory
- 25. Engines
- 26. seminars
- 27. A
- 28. B
- 29. C
- 30. C

## **Section 4**

- 31. Supportive
- 32. Attention
- 33. Steps
- 34. Consistent
- 35. graphics
- 36. Tone
- 37. silence(s)
- 38. Verbs
- 39. Repeat
- 40. predicting

## **Test 4**

### **Section 1**

1. wife
2. staff
3. students
4. 10th December
5. 6
6. dictionaries
7. Maker
8. Tapes
9. Photos
10. Speech

## **Section 2**

11. B
12. A
13. A
14. A
15. B
16. 180
17. Nearest station
18. Local history
19. 690
20. Walking club

## **Section 3**

21. 20 balloons
22. measurement(s)
23. Rock
24. crystals
25. String
26. Light
27. H
28. B
29. E
30. C

## **Section 4**

31. 795
32. Tail
33. Floor
34. Smell

- 35. A
- 36. A
- 37. B
- 38. B
- 39. B
- 40. E

## Test 5

### Section 1

- 1. Jamieson
- 2. afternoon
- 3. Communication
- 4. week
- 5. 10
- 6. Suit
- 7. Passport
- 8. Personality
- 9. Feedback
- 10. Time

### Section 2

- 11. A
- 12. B
- 13. A
- 14. C
- 15. River
- 16. 1422
- 17. Top
- 18. pass
- 19. Steam
- 20. Capital

### Section 3

- 21. G
- 22. F
- 23. A
- 24. E
- 25. B
- 26. C
- 27. C

- 28. A
- 29. B
- 30. D

#### **Section 4**

- 31. Shelter
- 32. Oil
- 33. roads
- 34. Insects
- 35. grass
- 36. water
- 37. Soil
- 38. Dry
- 39. Simple
- 40. Nests

## **Test 6**

#### **Section 1**

- 1. black
- 2. 2085
- 3. 9456 1309
- 4. 2020BD
- 5. July
- 6. B
- 7. D
- 8. F
- 9. \$25
- 10. Next week

#### **Section 2**

- 11. Route book
- 12. 900 miles
- 13. North Africa
- 14. A
- 15. C
- 16. B
- 17. C

- 18. E
- 19. B
- 20. D

### **Section 3**

- 21. Friday
- 22. Biology
- 23. 57
- 24. 43
- 25. Wednesday
- 26. Recording lectures
- 27. skimming
- 28. French revolution
- 29. Why study history
- 30. Animal language

### **Section 4**

- 31. Four-month certificate
- 32. Employment
- 33. One-year diploma
- 34. No qualifications
- 35. Six-month certificate
- 36. C
- 37. F
- 38. B
- 39. G
- 40. D

## **Test 7**

### **Section 1**

- 1. 208 613 2978
- 2. Visiontech
- 3. Doctor
- 4. Garage
- 5. Furniture
- 6. Fridge
- 7. School
- 8. 950 dollars
- 9. Quiet
- 10. Friend

## **Section 2**

- 11. Contact
- 12. Emergency
- 13. Radio
- 14. keys
- 15. locks
- 16. C
- 17. D
- 18. F
- 19. G
- 20. E

## **Section 3**

- 21. C
- 22. A
- 23. B
- 24. C
- 25. A
- 26. G
- 27. A
- 28. D
- 29. C
- 30. E

## **Section 4**

- 31. food
- 32. hero
- 33. Feathers
- 34. Shells
- 35. diamond
- 36. shark
- 37. teeth
- 38. messages
- 39. Meeting
- 40. escape

## **Test 8**

### **Section 1**

1. listening
2. vocabulary
3. general
4. 15
5. department
6. May
7. Week 5
8. B
9. D
10. G

### **Section 2**

11. C
12. A
13. B
14. B
15. C
16. B
17. E
18. G
19. C
20. A

### **Section 3**

21. D
22. C
23. B
24. third
25. industry
26. plan(s)
27. laboratory
28. seminar(s)
29. pairs
30. Interview

### **Section 4**

31. narrower
32. garden(s)
33. superstore(s)
34. glass

- 35. Older
- 36. Waste
- 37. windfarm(s)
- 38. B
- 39. C
- 40. E

## Test 9

### Section 1

- 1. A radio program
- 2. LS142JW
- 3. hennings.co.uk
- 4. two/2
- 5. Joint membership
- 6. forty-nine/49
- 7. The union bank
- 8. 15th october
- 9. JYZ37
- 10. Video

### Section 2

- 11. Lake
- 12. Picnic
- 13. Flowers
- 14. twenty/20
- 15. Motor
- 16. Art gallery
- 17. Concert hall
- 18. 2:30
- 19. C
- 20. B

### Section 3

- 21. Classical history
- 22. compulsory
- 23. Object matters
- 24. Classification

- 25. coursework
- 26. Towns and cities
- 27. The origins
- 28. Oral
- 29. seminars
- 30. Location

#### **Section 4**

- 31. A
- 32. B
- 33. B
- 34. B
- 35. C
- 36. A
- 37. B
- 38. A
- 39. B
- 40. C

## **Test 10**

#### **Section 1**

- 1. 3.5 kilograms
- 2. 0.5
- 3. 37.5 cm
- 4. 2.5 hours
- 5. wireless
- 6. headphone(s)
- 7. 300
- 8. Bristow
- 9. 09875423387
- 10. 22nd October

#### **Section 2**

- 11. B
- 12. D
- 13. Beach shop
- 14. Seating
- 15. 9:30 am
- 16. A
- 17. B

- 18. A
- 19. A
- 20. C

### **Section 3**

- 21. 20 minutes
- 22. Reading
- 23. B
- 24. A
- 25. C
- 26. A
- 27. A
- 28. B
- 29. A
- 30. A

### **Section 4**

- 31. mood
- 32. Time-consuming
- 33. Simpler
- 34. media
- 35. card(s)
- 36. tourists
- 37. directions
- 38. Mixed
- 39. 3
- 40. 71

## **Test 11**

### **Section 1**

- 1. warehouse
- 2. Hitcher
- 3. supermarket
- 4. bakery
- 5. ARW204
- 6. adverts / advertisements
- 7. newspaper
- 8. agency

- 9. tutors
- 10. feedback

## **Section 2**

- 11. forts
- 12. Saxon times
- 13. woollen cloth
- 14. Vikings / Viking invasions
- 15. financial administration
- 16. three castles
- 17. survey
- 18. taxes
- 19. Roman walls
- 20. (wooden) drawbridge

## **Section 3**

- 21. A
- 22. B
- 23. A
- 24. C
- 25. B
- 26. C
- 27&28. IN EITHER ORDER
- 27. B
- 28. E
- 29&30. IN EITHER ORDER
- 29. A
- 30. D

## **Section 4**

- 31. Acronym
- 32. phenomenon
- 33. B/G (any order)
- 34. B/G (any order)
- 35. chip
- 36. hole
- 37. Wavelength
- 38. three primary colours
- 39. watermarks
- 40. organic compounds

# Test 12

## Section 1

1. club
2. male
3. drive
4. Tuesday
5. August
6. dinner
7. 25
8. 16
9. modern
10. hospital

## Section 2

11. peach-blossom
12. square-shaped
13. bamboo-pattern cabinets
14. dessert course
15. (cast) iron columns
16. smoke jack
17. (lotus-shaped) chandeliers
18. servant's room
19. carpet
20. fine silk

## Section 3

21. C
22. A
23. C
24. B
25. B
26. C
27. F
28. E
29. D
30. G

## Section 4

31. acute pain / localised pain
32. CNS / central nervous system

33. spinal cord
34. neurons / nerve impulses
35. pain signal
36. B
37. individual's sensitivity
38. anti-inflammatory drugs
39. natural painkiller
40. 30%

## Test 13

### Section 1

1. Jamieson
2. 11th July
3. waiter(s)
4. sing
5. children
6. drive
7. transport
8. meal
9. Thursday
10. Photo

### Section 2

11. GM / genetically modified
12. (free-range) eggs
13. £1.59
14. one third / 1/3 / a third
15. jasmine & lavender
16. C/F (any order)
17. 17. C/F (any order)
18. 18. B/E (any order)
19. B/E (any order)
20. bottle of wine

### Section 3

21. A
22. C
23. A
24. C
25. B
26. B
27. sharing

- 28. education
- 29. settle down
- 30. gifts

#### **Section 4**

- 31. relative velocities
- 32. direct proportion
- 33. action-reaction
- 34. zero / 0
- 35. objects move/object moves
- 36. magnitude
- 37. free fall
- 38. force of repulsion/ repulsion force
- 39. integrity
- 40. Parallel

## **Test 14**

#### **Section 1**

- 1. Children
- 2. 4
- 3. radio
- 4. Evening
- 5. 5 candles
- 6. Tuesday
- 7. donation
- 8. piano
- 9. discount
- 10. singer

#### **Section 2**

- 11. seven white cliffs
- 12. (crystal-clear) lake
- 13. weather
- 14. unexplored/untouched beach
- 15. sunbathing
- 16. water sports
- 17. canoes
- 18. life-saving jackets
- 19. paragliding



20. fire

### **Section 3**

- 21. B
- 22. A
- 23. A
- 24. C
- 25. B
- 26. B
- 27. A
- 28. C
- 29. E
- 30. F

### **Section 4**

- 31. non-renewable
- 32. industrial boilers
- 33. architectural strategies
- 34. release
- 35. offshore regions
- 36. kinetic energy
- 37. volcanic locations
- 38. Iceland
- 39. gasoline additive
- 40. 2.7%

## **Test 15**

### **Section 1**

- 1. 077876345
- 2. 27(th) February/Feb.
- 3. Akendale
- 4. 3,450
- 5. books
- 6. paintings
- 7. mirror
- 8. desk
- 9. leg
- 10. plates

## **Section 2**

- 11. photo
- 12. clock in
- 13. cash up
- 14. stocktake
- 15. log out
- 16. third floor
- 17. swipe
- 18. lockers
- 19. black trousers
- 20. nail polish

## **Section 3**

- 21. B
- 22. B
- 23. A
- 24. C
- 25. C
- 26. C
- 27. G
- 28. B
- 29. E
- 30. F

## **Section 4**

- 31. B
- 32. wetlands
- 33. coal mines / digging the earth
- 34. breeding areas
- 35. north
- 36. covered by ice
- 37. sense of smell
- 38. oxygen depletion
- 39. Eucalyptus leaves
- 40. high sand temperatures

# **Test 16**

## **Section 1**

- 1. arthritis
- 2. knee

3. 10 thousand
4. mortgage
5. competition
6. cousin
7. conceited
8. contract
9. Steel workers
10. 25th wedding

## **Section 2**

11. C
12. D
13. E
14. A
15. E
16. B
17. C
18. A
19. A
20. A

## **Section 3**

21. B
22. A
23. C
24. B
25. D
26. full-time
27. term
28. intensive
29. diploma
30. topic

## **Section 4**

31. politics
32. learn
33. Children's education
34. Car
35. Nursing
36. crisis
37. pensions
38. confidence
39. management
40. well-informed

# Test 17

## Section 1

1. 3
2. brakes
3. overseas
4. 1500
5. 6:30
6. 88 Princess
7. B
8. C
9. C
10. A

## Section 2

11. Temperate rainforest
12. Shallower water
13. Hot spring
14. curious
15. Fierce
16. solitary
17. Engine
18. rope(s)
19. Orange
20. Pills

## Section 3

21. 200
22. 4 week
23. 8
24. 10 minute
25. skil(s)
26. Travel
27. A
28. C
29. B
30. C

## Section 4

31. A
32. C

- 33. B
- 34. Layout
- 35. Letters
- 36. Work
- 37. Accuracy
- 38. Speed
- 39. Mile
- 40. Dominant

## Test 18

### Section 1

- 1. Alex
- 2. 3
- 3. 8 November
- 4. 5
- 5. 108 park
- 6. grandmother
- 7. Sleeping
- 8. dress
- 9. tuesday
- 10. 4pm

### Section 2

- 11. hobby
- 12. car
- 13. kitchen
- 14. Presents
- 15. elderly
- 16. projects
- 17. internet
- 18. Library
- 19. active/busy
- 20. Twelve

### Section 3

- 21. B
- 22. C
- 23. B
- 24. A
- 25. A
- 26. A
- 27. C
- 28. C
- 29. B

30. C

#### **Section 4**

- 31. 5000 BC
- 32. Worms
- 33. Historical evidence
- 34. Ancient Egypt
- 35. Olive oil
- 36. Onions
- 37. Historian
- 38. Extract
- 39. Middle ages
- 40. Modern

## **Test 19**

#### **Section 1**

- 1. Sharpe
- 2. Beaconsfield
- 3. 0374 55 793
- 4. MH 66 G4
- 5. Credit card
- 6. Gold star
- 7. Mid-winter
- 8. 16 January
- 9. Taxi
- 10. Bicycle

#### **Section 2**

- 11. Front
- 12. Staircase
- 13. Security
- 14. Wall
- 15. 10
- 16. C
- 17. A
- 18. B
- 19. D
- 20. E

### **Section 3**

21. Plan
22. Responsibilities
23. Service
24. Reference
25. Methodology
26. Websites
27. H
28. B
29. G
30. E

### **Section 4**

31. Inhabitants
32. Asia
33. Civilisation
34. Settlers
35. Whalers
36. Tents
37. Boats
38. Dogsled
39. Bowhead
40. Population

## **Test 20**

### **Section 1**

1. 14 Hill
2. 22 376 76
3. 1 year
4. Intermediate
5. North west
6. Vegetarian
7. Facilities
8. Garden
9. 100
10. 23rd March

### **Section 2**

11. Clubhouse
12. Picnic
13. Prizes

- 14. Junior
- 15. 8:30 AM
- 16. 4
- 17. Sunday
- 18. D
- 19. F
- 20. B

### **Section 3**

- 21. B
- 22. C
- 23. F
- 24. A
- 25. C
- 26. B
- 27. A
- 28. C
- 29. A
- 30. A

### **Section 4**

- 31. Message
- 32. Media
- 33. Cost -effective
- 34. Habits
- 35. Recognise
- 36. Image
- 37. Servies
- 38. Locations
- 39. Perfume
- 40. Supportive

## **Test 21**

### **Section 1**

- 1. 190
- 2. 6 months
- 3. Easymove
- 4. TV
- 5. microwave/oven
- 6. Fridge
- 7. gas

- 8. Jacobs
- 9. 4 lion
- 10. 099 547 218 23

## **Section 2**

- 11. A
- 12. B
- 13. C
- 14. Differentiate
- 15. Simplified pricing
- 16. Creative marketing
- 17. Cooking demonstrations
- 18. Tree lightings
- 19. B
- 20. E

## **Section 3**

- 21. exhibition
- 22. Commercial
- 23. Geometric
- 24. Slender
- 25. Decoration
- 26. streamlined
- 27. Horizontal
- 28. A
- 29. C
- 30. A

## **Section 4**

- 31. Empire
- 32. Modern
- 33. Maize
- 34. Bean
- 35. Social
- 36. Dyes
- 37. Crafts
- 38. Leadership
- 39. Temples
- 40. Precious

# **Test 22**

## **Section 1**

- 1. B
- 2. C

- 3. B
- 4. A
- 5. 15 sportsman
- 6. 0414 658 339
- 7. igo.com
- 8. B
- 9. C
- 10. D

## **Section 2**

- 11. Breakfast
- 12. paintings
- 13. Castle
- 14. Famous people
- 15. Antique shows
- 16. Old postcards
- 17. E
- 18. F
- 19. A
- 20. D

## **Section 3**

- 21. B
- 22. E
- 23. Smith Brothers
- 24. Choosing University courses
- 25. Printers Limited
- 26. Surviving university
- 27. 2004
- 28. B
- 29. E
- 30. F

## **Section 4**

- 31. Crisis
- 32. Knowledge
- 33. Market
- 34. Obvious
- 35. director
- 36. regional
- 37. group
- 38. C
- 39. B
- 40. C

# Test 23

## Section 1

1. 40
2. 4:05 AM
3. Commitments
4. 07-Aug
5. unpack
6. Post
7. carry-on
8. Suitcase
9. L4GBWF
10. Aisle

## Section 2

11. Serious assaults
12. Isolated roads
13. Emergency vehicle
14. Occupied house
15. Corner
16. E
17. B
18. A
19. C
20. D

## Section 3

21. monarchy
22. general
23. Executive
24. Makes
25. Interprets
26. A
27. C
28. C
29. B
30. A

## Section 4

31. C
32. D
33. B
34. F
35. A

- 36. E
- 37. Individual
- 38. Core group
- 39. Options
- 40. Final decision

## Test 24

### Section 1

- 1. Writing workshop
- 2. ten
- 3. prescribed/set
- 4. History
- 5. 3:30 PM
- 6. Cake decorating
- 7. Booking
- 8. Social networking
- 9. Work life balance
- 10. Central library

### Section 2

- 11. B
- 12. C
- 13. A
- 14. A
- 15. C
- 16. E
- 17. ring
- 18. Plugs
- 19. Outside
- 20. heaters

### Section 3

- 21. survival
- 22. Threatened
- 23. Seasonal fluctuations
- 24. Shallow
- 25. Refuge areas
- 26. Purity
- 27. F
- 28. E
- 29. C



30. D

#### **Section 4**

- 31. sun/wind
- 32. wind/sun
- 33. puffy
- 34. horizontal
- 35. fog
- 36. hair-like
- 37. Produce
- 38. Droplets
- 39. Raindrops
- 40. expansion

## **Test 25**

#### **Section 1**

- 1. Durham
- 2. 7848 3762
- 3. Trader
- 4. 17 Brown
- 5. 4065
- 6. 6 months
- 7. Washing machine
- 8. 750
- 9. Water
- 10. Noisy

#### **Section 2**

- 11. air-conditioned
- 12. Hope
- 13. Rainforest
- 14. Photo opportunity
- 15. Reception desk
- 16. Green mountain
- 17. Senior citizen
- 18. 8:30 AM
- 19. Coach travel
- 20. Entrance fees

#### **Section 3**

- 21. B
- 22. A
- 23. A

- 24. C
- 25. B
- 26. D
- 27. A
- 28. E
- 29. C
- 30. G

#### **Section 4**

- 31. Reactions
- 32. Environmental
- 33. Personal
- 34. Surroundings
- 35. places/ areas
- 36. Presence
- 37. Uneasy
- 38. Parts
- 39. Aversion
- 40. Dark

## **Test 26**

#### **Section 1**

- 1. Driver's licence
- 2. AY 196310
- 3. May 19
- 4. 29 Sunset
- 5. Motorcar
- 6. Dangerous driving
- 7. Blue
- 8. First vehicle
- 9. Car hire
- 10. 0.75%

#### **Section 2**

- 11. A
- 12. C
- 13. A
- 14. B
- 15. B
- 16. B
- 17. A
- 18. C
- 19. G

20. E

### **Section 3**

- 21. support
- 22. Clay
- 23. cork
- 24. Solution
- 25. mesh/lid
- 26. B
- 27. E
- 28. A
- 29. C
- 30. E

### **Section 4**

- 31. Rhyme
- 32. Thirty
- 33. French
- 34. Promotion
- 35. Nature
- 36. Ex-convicts
- 37. Soldiers
- 38. Surgeons
- 39. Officers
- 40. Scandals

### **If you score...**

#### **0 - 12**

you are highly unlikely to get you may get an acceptable an acceptable score under I score under examination conditions and we recommend that you spend a lot of time improving I more practice or lessons your English before you take IELTS

**13 - 26** you may get an acceptable score under examination conditions but we recommended that you think about having more practice or lessons before you take IELTS

#### **27 - 40**

you are likely to get an acceptable score under examination conditions but remember that different institutions will find different scores acceptable.